

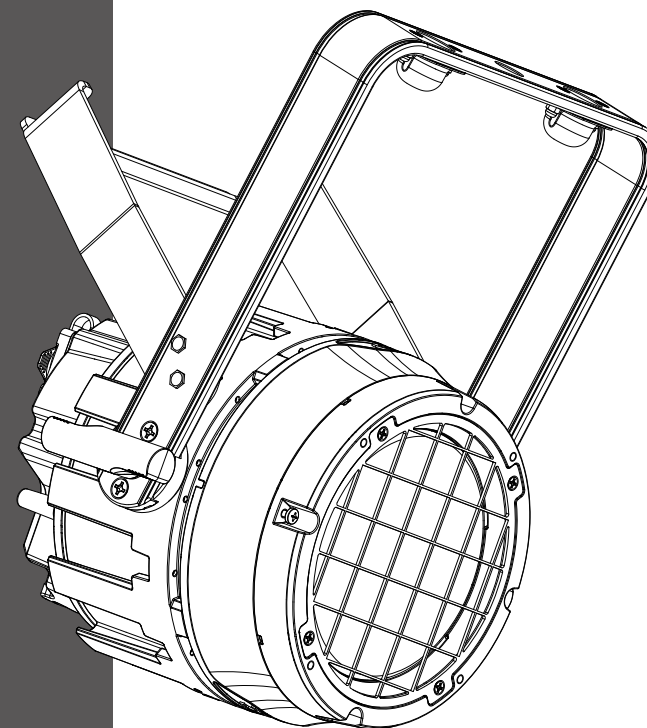

Mini Blinder



www.ckclighting.com

CKC LIGHTING CO.,LTD

Addr.:335 Nansha Avenue, Tung Chung Town,
Nansha District, Guangzhou City, China.
TEL: (020)3920 4506 FAX: (020)3920 4631
WEB: www.ckclighting.com



Before carrying out any installation, maintenance, or cleaning of the lighting fixtures, please confirm that the power has been cut off! Before using this fixture, please read this manual. Our company reserves the right to change product design and specifications without prior notice.

CONTENTS

1. Security Warning Information	1
2. Product Introduction	3
2.1 Exterior dimensions	3
2.2 Fixture included accessories	4
3. Main technical parameters of the equipment	4
4. Packaging and transportation	5
4.1 Disassemble packaging	5
4.2 Equipment installation	5
5. Installation Requirements Explanation	6
5.1 Clamp installation	6
5.2 Fixture installtion	7
5.3 Hanging Installation Diagram	7
6. Power and signal connection	8
6.1 Power and signal socket	8
6.2 Power Connect	8
6.3 Signal Connect	9
7. Control panel	9
7.1 Panel Introduction	9
7.2 System menu	10
8. DMX control channel table	12
9. Control circuit diagram	18
10. Regular maintenance	18
10.1 Cleaning and maintenance	18
10.2 Fault analysis and handling	19
Appendix: Optional accessories	20

★ Statement ★

- This manual contains important information on safe use and installation. Please read it carefully and follow the requirements for operation and installation. Please keep this manual properly;
- The equipment has good performance and complete packaging when it leaves the factory. The operator should strictly follow the warning items and operating instructions stated in the manual. Any malfunction or damage caused by misuse or neglect of the manual is not within the scope of our company's responsibility and warranty;
- The relevant information in this manual is for reference only. All lighting products are subject to the actual product. Any changes will not be notified separately, and our company reserves the right of final interpretation.

1. Security Warning Information



Attention !

Please read the safety requirements information in this section carefully before installing, powering on, operating, or repairing the lighting fixtures.



- This product is for professional use and is not suitable for other purposes;
- After receiving the lighting fixtures, please check if the packaging is complete and unpack to check if the equipment has been damaged due to transportation. If there is any damage caused by transportation, please do not use this lamp and contact local technicians or manufacturers as soon as possible;
- When transporting again, please use the original packaging materials;
- If there is obvious damage to the machine casing, it should be replaced in a timely manner;
- When hanging lamps, it is necessary to verify that the hanging equipment can withstand more than 6 times the weight of the lamp. After installation, it is necessary to verify that the lamp cover and installation buckle are secure and undamaged. At the same time, a safety rope should be used as an auxiliary safety for the lamp and fixed on the truss;
- The light source inside this luminaire should be replaced by the manufacturer, its service agent, or a similarly qualified person;
- If you have any other questions about how to safely operate the equipment, please contact our technical personnel or call our service hotline;
- This product has a protection level of IP65 and can be used both indoors and outdoors;



- Lighting fixtures should be kept clean and avoid prolonged use in overheated or dusty environments to prevent contact with chemical liquids;
- When using the product, attention should be paid to avoiding serious or fatal injuries caused by fire, heat, electrical shock, and ultraviolet radiation. Before powering on or installing, read the instruction manual first. Follow the safety precautions for operation and pay attention to the warning signs on the instructions and equipment;
- Only professionals are allowed to install, operate, and maintain lighting fixtures, and strictly follow the procedures stated in the operating instructions.



- The eyes cannot directly look at the luminous object;
- Do not connect this device to any dimmer;
- If visible damage occurs to the protective casing, lens, and display screen on the lighting fixture, it is considered as damage to the point of loss;
- Please do not place any filters or other items at the light outlet, and do not replace non original parts;
- The minimum safe illumination distance of the lamp is 1m.



- Before installation, please confirm that the power supply voltage used matches the voltage indicated on the light fixture. Each lighting fixture should be properly grounded and electrically installed according to relevant standards;
- Please disconnect the power before repairing or cleaning the equipment;
- During the operation of the lighting fixtures, touching the wires is prohibited to prevent electric shock;
- If the external soft cable or wire of this lamp is damaged, the wire should be replaced by the manufacturer, its agent, or a similarly qualified person to avoid danger;
- Avoid flammable liquids, water, or metal conductors from entering the interior of the lamp to prevent electric shock or fire. If any foreign objects enter the lamp, immediately cut off the power supply;
- When multiple lamps are operated in series, the signal lines can be connected in multiple ways, but the power supply must be connected separately.



- The lighting fixtures work normally at -20 °C to 45 °C . When replacing any components or accessories in the equipment, ensure that the power is disconnected to prevent electric shock and injury;
- The maximum surface temperature of the lamp during operation can reach 70 °C , please do not touch it with bare hands.



- The lighting fixtures must be installed in a sufficiently ventilated area, at least 0.5m away from adjacent surfaces, to ensure that no ventilation holes are blocked;
- Do not install the lighting fixtures directly on flammable objects;
- The minimum distance between all outer surfaces of the lamp and combustible materials is 0.5m.

2. Product Introduction

2.1 Exterior dimensions of lighting fixtures

Fixture dimensional drawing:

194 × 170 × 170 mm

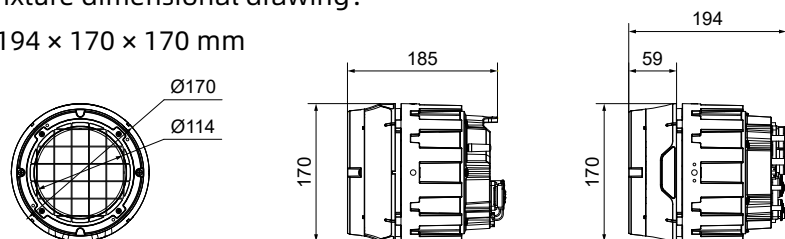

Dimensional drawing of folding clamp version

264 × 198 × 342 mm

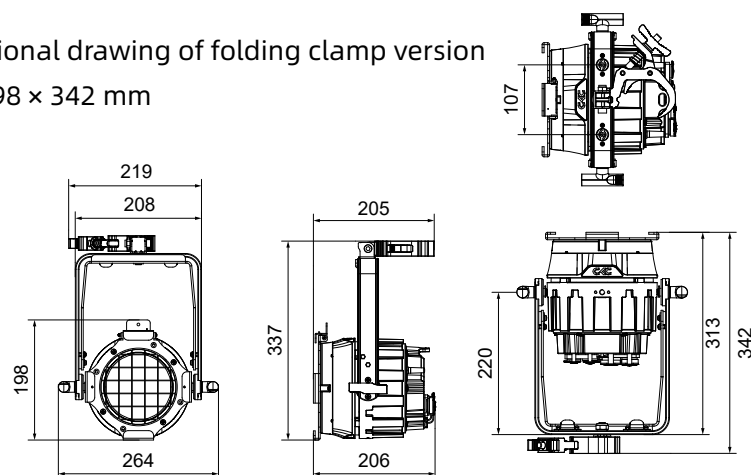

Dimensional drawing of Omega bracket version

264 × 170 × 301 mm

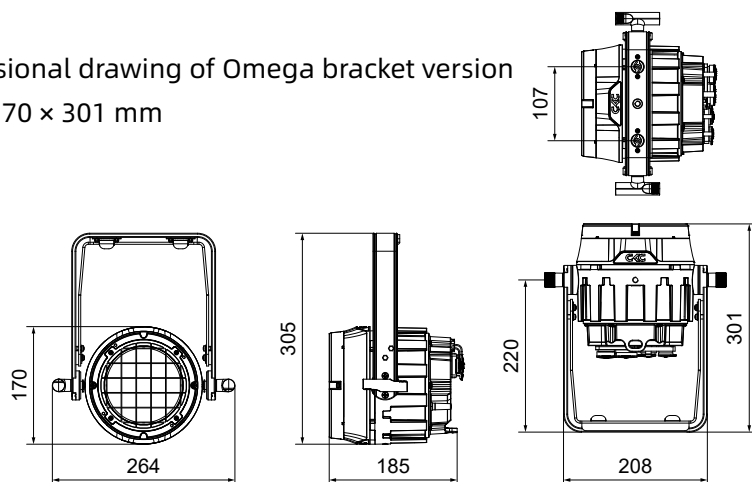

Fixed bracket installation version

264 × 275 × 195 mm

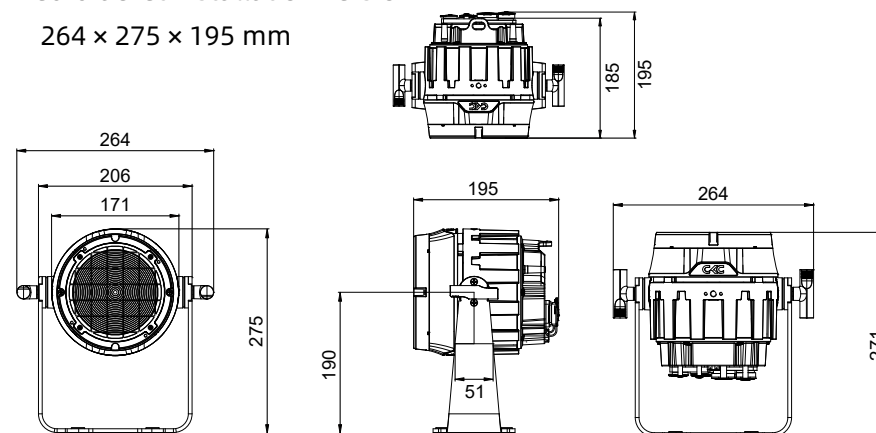

2.2. Fixture included accessories

Name	QTY	
Clamp	1	PCS
Safety cable	1	PCS
Refer to Appendix for More Optional Accessories		

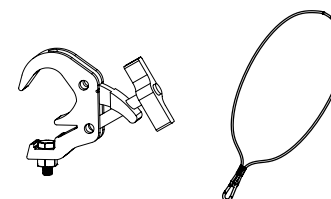

3. Main technical parameters of the equipment

Product execution standards: GB7000.1-2023, GB7000.217-2023, Q/YF-2017

● Electrical parameter

Rated input voltage: AC 100V-240V~ 50Hz/60Hz
 Rated power of the entire fixture: 270W Power factor: 0.99F
 Input Current: 1.25A 220V

● Source lifespan

> 20000 hours

● Optical system

Source: 84 × 3.5W RGBLAW LED CCT: 1800 ~ 8500 K
 Output luminous flux: 12700 Lm CRI: 92+
 Luminous Flux (with Optical Compound Eye Front Cover Assembly): 10400 Lm
 Beam angle: 46° (Optional: 34°)
 Field angle: 86° (Optional: 56°)

● Control and programming

Control channel: 1CH Dimmer / 2CH Dimmer & CCT / 3CH Dim/Strb/
CCT / 4CH IRGB / 6CH Raw Color / 7CH Dim/CCT/Clr / 14CH
Standard / 21CH Extended / 10CH RGB / 15CH RGB Extend /
10CH CMY / 15CH CMY Extend

Protocol: DMX512, RDM

Data connect: 3 PIN XLR

● Illumination draw

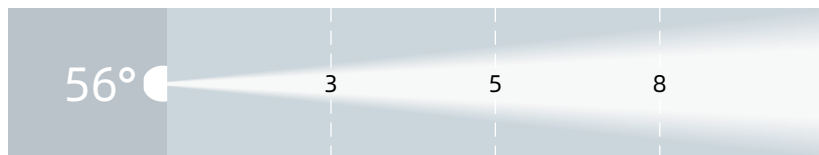

● Other effect function

ast electronic strobe: 1~25Hz

LED refresh rate: 900HZ~25KHZ

● Other features and functions

Weight: 3.7 KG (weight without bracket)

4.3 KG (Dual-bracket and fixed bracket installation version)

4. Packaging and transportation

4.1 Disassemble packaging



Notice: After receiving the fixture, please unpack and check for any damage caused by transportation. If there is any damage caused by transportation, please do not use this fixture and contact the local technical personnel or manufacturer as soon as possible.

4.2 Equipment packaging

- 1). Disconnect the power supply before packaging the lighting fixtures to allow them to cool completely;
- 2). Flight cases can only be stacked in two layers and are not allowed to be reversed.

5. Installation Requirements Explanation

5.1 Clamp install

The lighting fixtures can be installed on the stage or on any direction of the truss, and the clamp can be quickly and easily locked onto the truss.

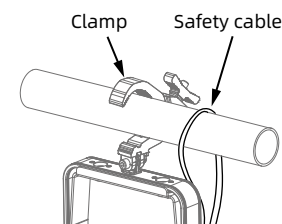

Warning !

The clamp is installed on the handle. Insert the clamp into the handle mounting hole horizontally and tighten it with bolts (the shape of clamp shall be subject to the actual object).

Integrated clamp installion

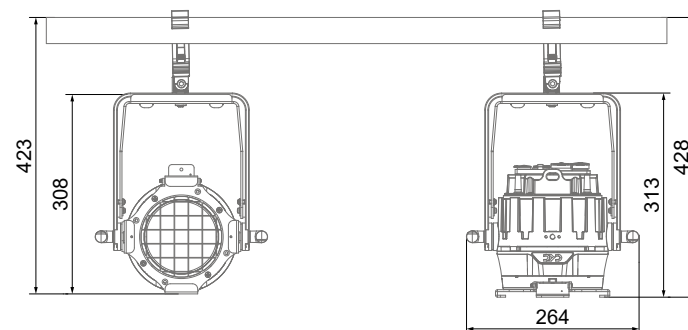
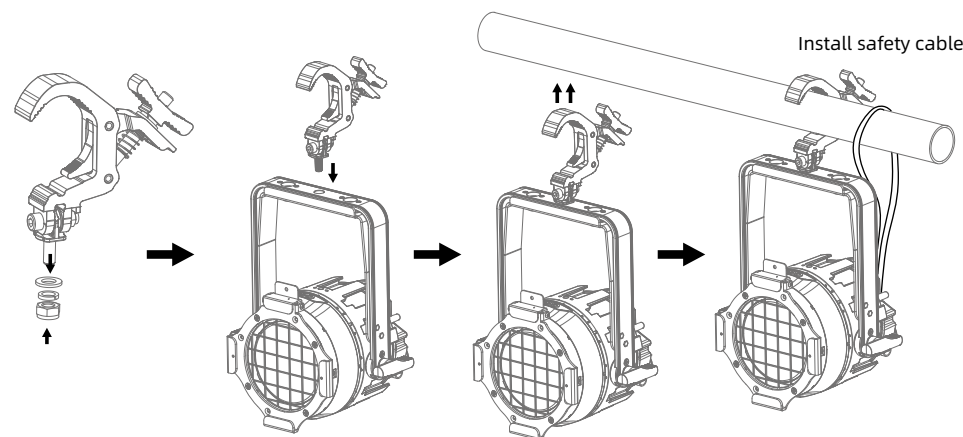

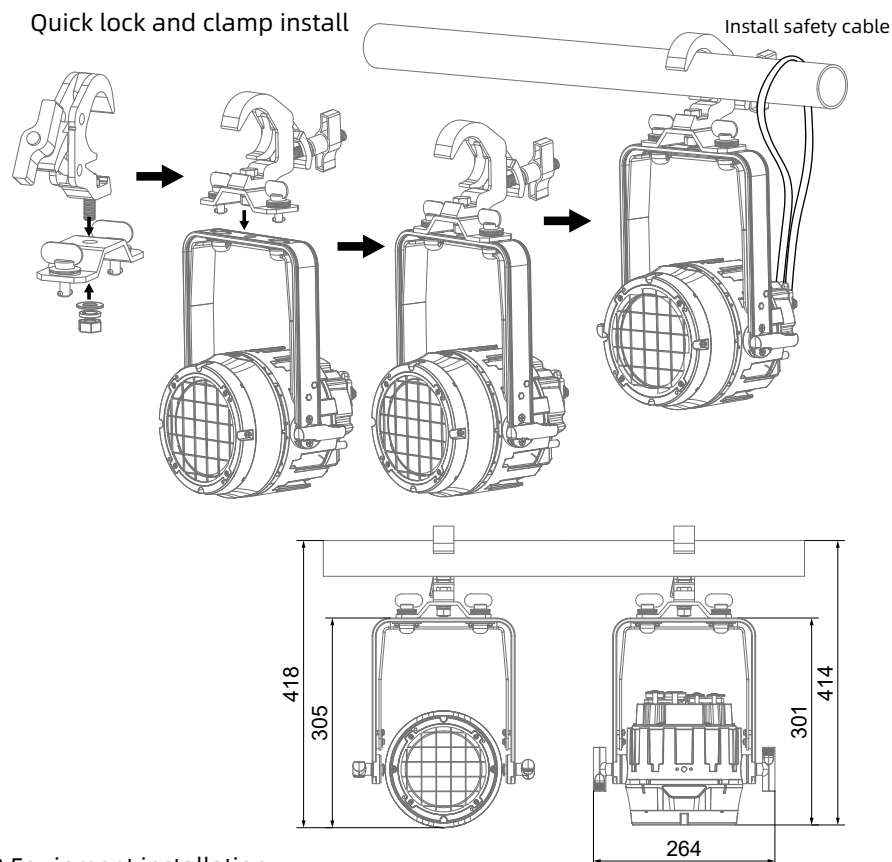

5.2 Equipment installation

- 1). Before installation, it is necessary to verify that the lamp hook and safety rope are not damaged, and that the installation object can withstand 6 times the total weight of the lamp and cable accessories;
- 2). Install the quick lock clamp on the base of the lamp body. Insert the clamp horizontally into the mounting hole of the base, rotate it clockwise 1/4 turn to lock it, and install the second clamp using the same method (the shape of the clamp should be based on the actual product).

5.3 Hanging Installation Diagram

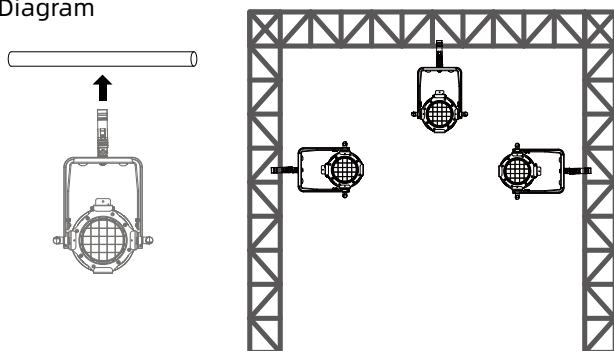

6. Power、Signal connect

6.1 Power and signal socket

- | | |
|--------------------|-------------------|
| 1、Power input | 2、Power output |
| 3、Breathable valve | 4、3Pin XLR female |
| 5、3Pin XLR male | |

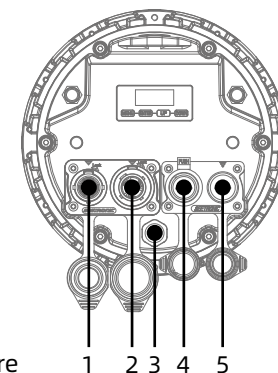

6.2 Power connect

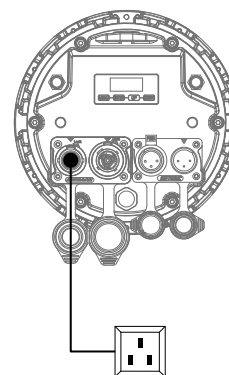

Connection method:

L(live wire) - brown wire

E(Ground wire) - yellow/green dual color line

N(Zero Line) - Blue Line

When connecting the power supply, please note that the voltage and frequency of the power supply must match the voltage and frequency marked on the light fixture. When multiple fixtures are used simultaneously, it is recommended to connect the power supply of each fixture separately, so that each fixture can be individually controlled for power on/off.



Attention: When connecting the power supply, the ground wire (yellow/green dual color wire) must be safely grounded and comply with all relevant electrical installation standards.



Power In

This product uses Powercon In/Out to connect power cable. Due to power limitations, a 2mm power cable can drive up to 8 fixtures at 220V, can drive up to 3 fixtures at 110V.



Warning !

- Do not connect too many fixtures or overload a single power cord;
- Do not use power cords with damaged insulation layers, and do not place power cords on other wires;
- When the fixture is not in use or cleaned, please unplug the power cord; Do not forcefully unplug or drag the power cord directly.

6.3 Signal connect

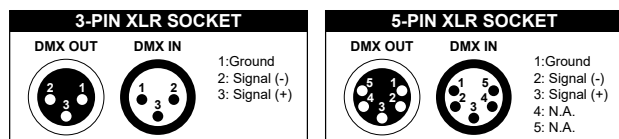

The lighting fixtures are equipped with standard DMX XLR input and output sockets. Please use DMX512 shielded twisted pair signal cables or Category 5 or above network twisted pair cables for connection. The typical connection distance for DMX signal lines is 150 meters. When transmitting signals over long distances, a DMX512 signal amplifier must be added.

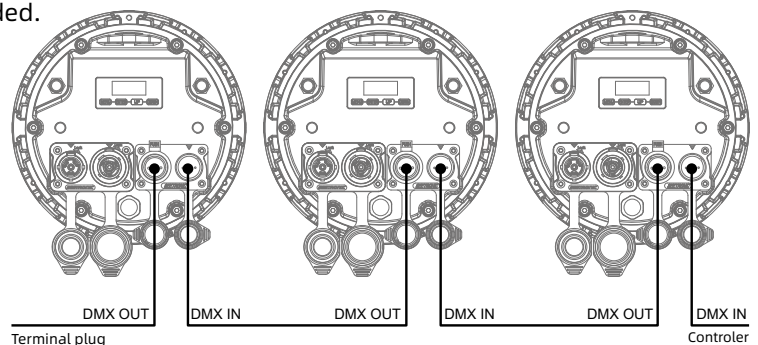

Connect a shielded twisted pair signal cable from the DMX output port of the controller to the DMX input port of the first device, and from the DMX output port of the first device to the DMX input port of the second device, and so on, until all the lamps are connected. Then install a terminal plug on the last 3 pin socket of each connected lamp output. (Weld a 4/1W, 120 Ω resistor between the 2 and 3 pins of a 3 or 5 core pin XLR plug).

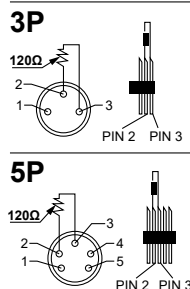

7. Control panel

7.1 Panel Introduction

- Adopting OLED display screen;
- Press the MENU key to view or modify fixture function settings, and press UP and DOWN;
- Press the ENTER key to confirm your selected function menu, which will take you to the corresponding sub menu in the menu. Each menu item represents a specific function of the lighting fixture (as shown in the table below);
- Press the ENTER key to save your modifications or enter a submenu, and press the UP or DOWN key to modify values (increase or decrease values);
- Press the MENU key to return to the previous menu or exit.

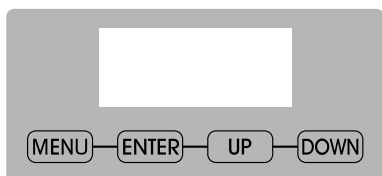

7.2. System menu

Note: The gray color block is the default setting value

DMX	Software Update Please Wait CKC	
	DMX Address	001 - 512
	DMX Mode	1CH Dimmer
		2CH Dimmer & CCT
		3CH Dim/Strb/CCT
		4CH IRGB
		6CH Raw Color
		7CH Dim/CCT/Clr
		14CH Standard
		21CH Extended
		10CH RGB
		15CH RGB Extend
		10CH CMY
		15CH CMY Extend
	No DMX Status	Hold Last
		Fade to Black
		Standalone
Array Mode	(Main Fixture Settings Only)	
	DMX Start Address	001 - 512
	DMX Mode	1CH Dimmer
		2CH Dimmer & CCT
		3CH Dim/Strb/CCT
		4CH IRGB
		6CH Raw Color
		7CH Dim/CCT/Clr
		14CH Standard
		21CH Extended
		10CH RGB
		15CH RGB Extend
		10CH CMY
		15CH CMY Extend
	Dimmer	000% - 100%
		Red
		Green
		Blue
		Mint
Control	Manual Color	Amber
		White
		CCT
		1800K - 8500K (Default = 6000K).

		Green Shift	-100% ~ +100% (Default = 0)
		Virtual Color	See Color Macros
	Master	On / Off	
	Slave	On / Off	
	Self Test	All	
		Dimmer	
		Color	
Settings	Output Mode	Blinder Output	
		Constant Output	
	Dim Modes	Standard	
		Stage	
		TV	
		Architectural	
		Theatre	
		Stage 2	
		Dim Speed	0-10s (Default = 0.1s)
	Dim to Warm	On / Off	
	Dim Curves	Linear	
		Square	
		Square Inverse	
		S-Curve	
	LED Refresh Rate	900Hz - 1500Hz, 2500Hz, 4000Hz, 5000Hz, 6000Hz, 10kHz, 15kHz, 20kHz, 25kHz (Default = 1200 Hz)	
	Color Tuning	Highest Fidelity	
		Balanced Output and Fidelity	
		Highest Output	
	Output Balance	Bright (Highest Output)	
		Uniform (Elation Full Spectrum Match)	
	LED Power Limit	50%	
		60%	
		70%	
		80%	
		90%	
		100%	
	Display	Screen Delay	10s - 5min (Default = 1 min)
		Screen Lock	OFF / ON / ON1
		Rotate Display	Yes / No / Auto
	Reset Defaults	Yes / No	
	Time	Current Run Time	
		Total Run Time	

Info	Temperature	Last Run Time
		Current
		Max Resettable
	DMX Values	Red
		Green
		...
	Product IDs	RDM UID
	Error Logs	Fixture Errors
Service (Passcode =050)	Software Version	1U:V1.04
		2U:V1.04
	Calibration	Red 000 - 255
		Green 000 - 255
		Blue 000 - 255
		Mint 000 - 255
		Amber 000 - 255
		White 000 - 255
	Reset Last Run	Yes / No
	Reset Error Logs	Yes / No

8.DMX control channel table :

1CH	2CH	3CH	4CH	6CH	7CH	14CH	21CH	RGB 10CH	RGB 15CH	CMY 10CH	CMY 15CH	Value	Function
1	1	1	1		1	1	1	1	1	1	1	0-255	Dimmer
													Intensity 0 → 100%
					2	2	2	2	2	2	2	0-255	Dimmer Fine
													Fine Intensity Control
													Shutter/Strobe
												0-31	Shutter closed
												32-63	No function (shutter open)
												64-95	Strobe effect slow to fast
			2		3	3	3	3	3	3	3	96-127	No function (shutter open)
												128-159	Pulse-effect in sequences
												160-191	No function (shutter open)
												192-223	Random strobe effect slow to fast
												224-255	No function (shutter open)
				2	1	4	4	4	4			0-255	Red
													0 → 100%
							5		5			0-255	Red Fine
													Fine Adjustment
				3	2	5	6	5	6			0-255	Green
													0 → 100%

						7		7			0-255	Green Fine Fine Adjustment
			4	3		6	8	6	8		0-255	Blue 0 → 100%
							9		9		0-255	Blue Fine Fine Adjustment
				4		7	10				0-255	Lime 0 → 100%
							11				0-255	Lime Fine Fine Adjustment
				5		8	12				0-255	Amber 0 → 100%
							13				0-255	Amber Fine Fine Adjustment
				6		9	14				0-255	White 0 → 100%
							15				0-255	White Fine Fine Adjustment
									4	4	0-255	Cyan 0 → 100%
										5	0-255	Cyan Fine Fine Adjustment
									5	6	0-255	Magenta 0 → 100%
										7	0-255	Magenta Fine Fine Adjustment
									6	8	0-255	Yellow 0 → 100%
									9		0-255	Yellow Fine Fine Adjustment
2	3				4	10		7		7		CCT Presets
											0-17	Open
											18-85	1800K → 8500K (See Sheet)
											86-255	8500K
												Variable CCT
						16		10		10	0-17	Open
											18-255	1800K → 8500K
						17		11		11	0-255	Variable CCT Fine Fine Adjustment
												Green Shift
											0	Idle
				5	11	18	8	12	8	12	1-127	Full Minus Green to Neutral
											128	Neutral White
											129-255	Neutral to Full Plus Green
												Color

												0	Open
												1-179	Virtual Swatch Book (See Table)
													Color Scroll
												180-201	Clockwise Fast → Slow
												202-207	Stop
												208-229	Counter-clockwise Slow → Fast
												230-234	Open
													Random Slots
												235-239	Fast
												240-244	Medium
												245-249	Slow
												250-255	Open
													Dim Modes
												0-20	Standard
												21-40	Stage
												41-60	TV
												61-80	Architectural
												81-100	Theatre
												101-120	Stage 2
													Dimmer Delay Time
												121	0s
												122	0.1s
												123	0.2s
												124	0.3s
												125	0.4s
												126	0.5s
												127	0.6s
												128	0.7s
												129	0.8s
												130	0.9s
												131	1.0s
												132	1.5s
												133	2.0s
												134	3.0s
												135	4.0s
												136	5.0s
												137	6.0s
												138	7.0s
												139	8.0s
												140	9.0s
												141	10s
												142-149	Idle
													Dim to Warm
												150-154	DTW On
												155-159	DTW Off

160-255	Idle
	Control
0-24	Idle
25-34	Blinder Output Mode
35-44	Constant Output Mode
45-99	Idle
	Refresh Rate (Hz)
100	900
101	910
102	920
103	930
104	940
105	950
106	960
107	970
108	980
109	990
110	1000
111	1010
112	1020
113	1030
114	1040
115	1050
116	1060
117	1070
118	1080
119	1090
120	1100
121	1110
122	1120
123	1130
124	1140
125	1150
126	1160
127	1170
128	1180
129	1190
130	1200
131	1210
132	1220
133	1230
134	1240
135	1250
136	1260
137	1270
138	1280
139	1290

7 14 21 10 15 10 15

140	1300
141	1310
142	1320
143	1330
144	1340
145	1350
146	1360
147	1370
148	1380
149	1390
150	1400
151	1410
152	1420
153	1430
154	1440
155	1450
156	1460
157	1470
158	1480
159	1490
160	1500
161	2500
162	4000
163	5000
164	6000
165	10000
166	15000
167	20000
168	25000
169-172	Idle
	Color Tuning
173-174	Idle
175-176	Highest Fidelity
177-178	Balanced Output and Fidelity
179-180	Highest Output (Default)
	Output Balance
181-182	Bright (Highest Output)
183-184	Uniform (Elation Full Spectrum Match)
185-200	Idle
	Dimmer Curves
201-210	Dimmer Curve: Linear (Default)
211-220	Dimmer Curve: Square
221-230	Dimmer Curve: Inverse Square
231-240	Dimmer Curve: S-Curve
241-255	Idle

Virtual Colors

Value	Filter Number	Name	Value	Filter Number	Name
1	7	Pale Yellow	32	49	Medium Purple
2	103	Straw	33	58	Lavender
3	151	Gold Tint	34	199	Palace Blue
4	100	Spring Yellow	35	119	Dark Blue
5	10	Medium Yellow	36	132	Medium Blue
6	101	Yellow	37	120	Deep Blue
7	104	Deep Amber	38	165	Daylight Blue
8	15	Deep Straw	39	161	Slate Blue
9	179	Loving Amber	40	118	Light Blue
10	21	Gold Amber	41	68	Sky Blue
11	105	Orange	42	143	Pale Navy Blue
12	158	Deep Orange	43	131	Marine Blue
13	22	Dark Amber	44	115	Peacock Blue
14	778	Millenium Gold	45	172	Lagoon Blue
15	135	Deep Golden Amber	46	116	Medium Blue Green
16	24	Scarlet	47	90	Dark Yellow Green
17	106	Primary Red	48	139	Primary Green
18	26	Bright Red	49	122	Fern Green
19	27	Medium Red	50	89	Moss Green
20	19	Fire	51	124	Dark Green
21	157	Pink	52	88	Lime Green
22	36	Medium Pink	53	138	Pale Green
23	111	Dark Pink	54	203	Quarter Ct Blue
24	128	Bright Pink	55	202	Half Ct Blue
25	148	Bright Rose	56	201	Full Ct Blue
26	332	Special Rose Pink	57	200	Double Ct Blue
27	793	Vanity Fair	58	206	Quarter Ct Orange
28	113	Magenta	59	205	Half Ct Orange
29	46	Dark Magenta	60	204	Full Ct Orange
30	48	Rose Purple	61-179		No Function
31	126	Mauve			

9. Control circuit diagram

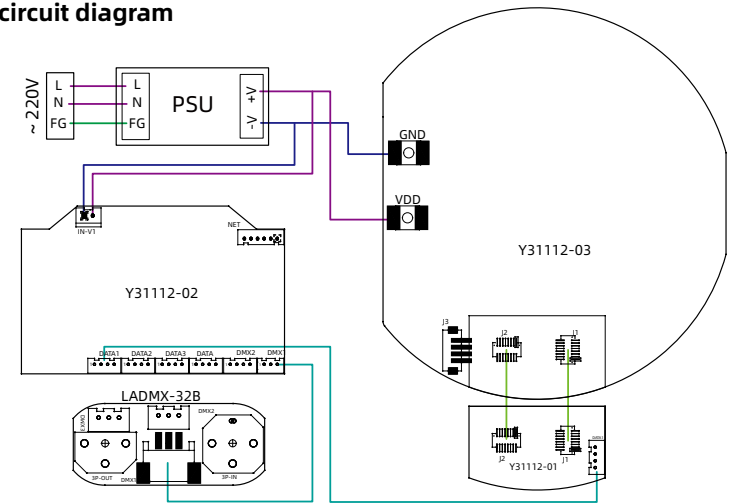

10. Regular maintenance

10.1 Cleaning and maintenance

Lighting fixtures require daily cleaning and maintenance, and their service life largely depends on the operating environment and standards. If you have any questions, please consult our technical engineers for advice. Maintenance and repair work not included in this book should be entrusted to our qualified technical engineers.



Attention! Damage caused by dust, e-liquid, or other reasons, as well as abnormal use, is not covered by the warranty.

**Warning !**

Before opening any lid, disconnect the power supply. Cleaning optical components requires gentle wiping as the coating surface is prone to scratching. Do not use damaging liquids or hard objects, as they may damage the plastic or coating surface.

- When the lens is cracked or otherwise damaged, it should be replaced in a timely manner;
- When the brightness significantly decreases, the LED may have reached its expiration date and should be replaced in a timely manner;
- When the fixture cannot start, please check if the fixture power fuse is blown. If it is blown, a fuse of the same specification must be used for installation;
- The fixture is equipped with a temperature protection device. When the temperature is too high, the protection device will automatically reduce power.
- When this situation occurs, please check whether the fan is running normally, whether the fan and fan mesh are clogged with dust, identify the fault and repair it before starting the fixture. Please note that only qualified technicians are allowed to carry out maintenance work;

10.2 Fault analysis and handling

Fault description	Analysis	Processing method
No action after power on	Check if the power switch is turned on	Turn on
	Check if the fuse is blown	Replace
	Check if the output of PSU is normal	Detecting voltage
	Check if poor contact in the internal circuit	Reconnect
Uncontrolled lighting fixtures	Check if the DMX signal cable is connected correctly	Reconnect or replace
	Check if the address code is correct and if the DMX mode of the lighting fixture matches the settings	Reconfirm
	The main control PCB is damaged	Replace
Not bright	LED aging or damage	Replace
	Power PCB malfunction	Check/ Replace
	Loose or poor contact of the circuit	Reconnect
	PSU malfunction	Replace
Automatically turn off or dim the lights	LED aging	Replace
	The temperature control switch is damaged	Replace
Weak light efficiency and uneven light spot	LED aging	Replace
	The optical mirror has accumulated dust or stains	Clean
	The optical mirror is damaged	Replace
Impure color	Weakening of light efficiency	Replace led PCB
 Attention! The above analysis is for abnormal reference only. Non professionals are not allowed to disassemble and repair the machine		

Appendix: Optional accessories

Hanging bracket assembly installation

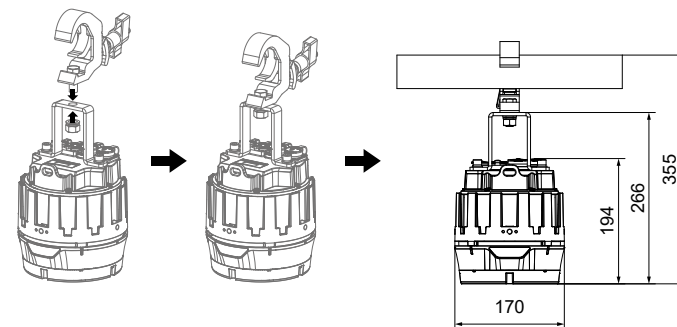

Clamp Hanging pin assembly installation

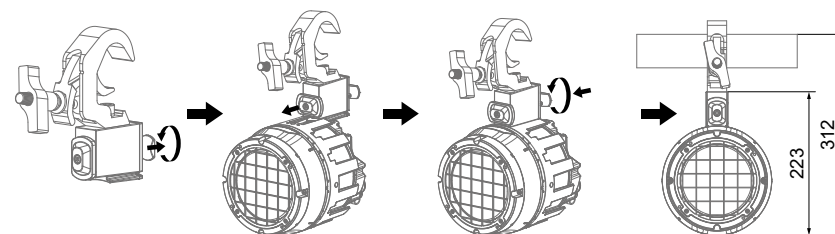

Splice lock assembly installation

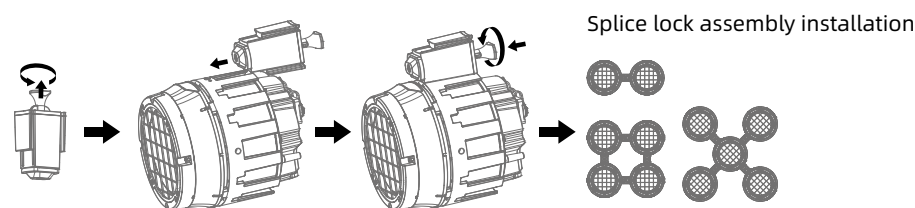

Barndoor assembly installation

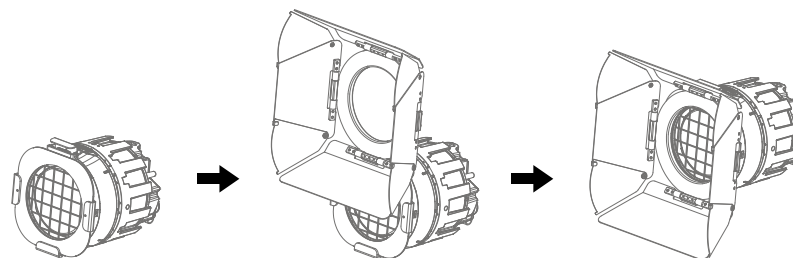

Bowen adapter assembly installation

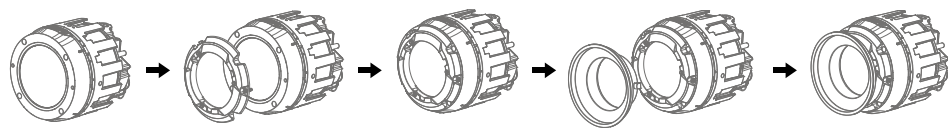

Gel frame holder assembly installation

