

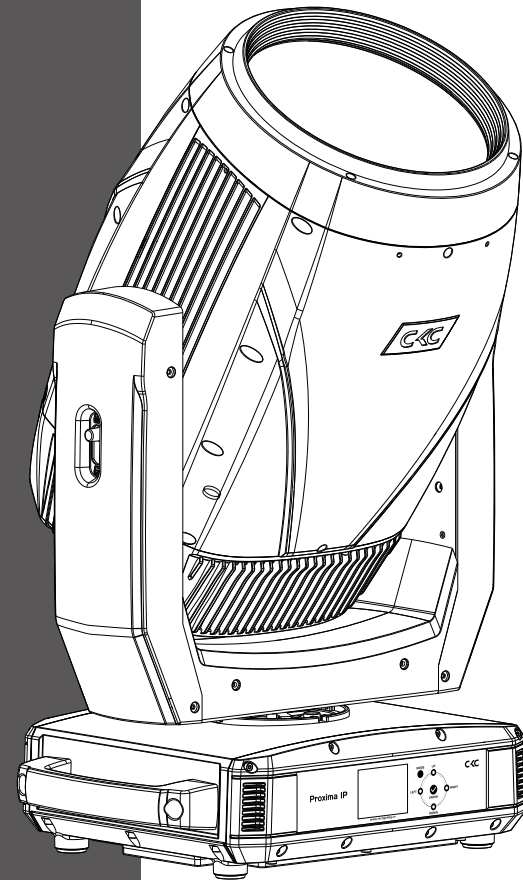

Proxima IP



www.ckclighting.com

CKC LIGHTING CO.,LTD

Addr.:335 Nansha Avenue, Tung Chung Town,
Nansha District, Guangzhou City, China.
TEL: (020)3920 4506 FAX: (020)3920 4631
WEB: www.ckclighting.com



Before carrying out any installation, maintenance, or cleaning of the lighting fixtures, please confirm that the power has been cut off! Before using this fixture, please read this manual. Our company reserves the right to change product design and specifications without prior notice.

CONTENTS

1. Security Warning Information	1
2. Product Introduction	3
2.1 Exterior dimensions	3
2.2 Fixture packaging accessories	3
3. Main technical parameters of the equipment	3
4. Packaging and transportation	6
4.1 Disassemble packaging	6
4.2 Equipment installation	6
5. Installation Requirements Explanation	6
5.1 Clamp installation	6
5.2 Fixture installtion	8
5.3 Hanging Installation Diagram	8
6. Power and signal connection	9
6.1 Power and signal socket	9
6.2 Power Connect	9
6.3 Signal Connect	10
7. Control panel	11
7.1 Panel Introduction	11
7.2 System menu	11
8. DMX control channel table	13
9. Control circuit diagram	18
10. Regular maintenance	19
10.1 Cleaning and maintenance	19
10.2 Fault analysis and handling	19

★ Statement ★

- This manual contains important information on safe use and installation. Please read it carefully and follow the requirements for operation and installation. Please keep this manual properly;
- The equipment has good performance and complete packaging when it leaves the factory. The operator should strictly follow the warning items and operating instructions stated in the manual. Any malfunction or damage caused by misuse or neglect of the manual is not within the scope of our company's responsibility and warranty;
- The relevant information in this manual is for reference only. All lighting products are subject to the actual product. Any changes will not be notified separately, and our company reserves the right of final interpretation.

1. Security Warning Information



Attention !

Please read the safety requirements information in this section carefully before installing, powering on, operating, or repairing the lighting fixtures.



- This product is for professional use and is not suitable for other purposes;
- After receiving the lighting fixtures, please check if the packaging is complete and unpack to check if the equipment has been damaged due to transportation. If there is any damage caused by transportation, please do not use this lamp and contact local technicians or manufacturers as soon as possible;
- When transporting again, please use the original packaging materials;
- If there is obvious damage to the machine casing, it should be replaced in a timely manner;
- When hanging lamps, it is necessary to verify that the hanging equipment can withstand more than 6 times the weight of the lamp. After installation, it is necessary to verify that the lamp cover and installation buckle are secure and undamaged. At the same time, a safety rope should be used as an auxiliary safety for the lamp and fixed on the truss;
- The light source inside this luminaire should be replaced by the manufacturer, its service agent, or a similarly qualified person;
- If you have any other questions about how to safely operate the equipment, please contact our technical personnel or call our service hotline;
- This product has a protection level of IP65 and can be used both indoors and outdoors;
- Avoid direct external strong light shining on the lens, which may cause the lens to focus and burn out internal components.



- Lighting fixtures should be kept clean and avoid prolonged use in overheated or dusty environments to prevent contact with chemical liquids;
- When using the product, attention should be paid to avoiding serious or fatal injuries caused by fire, heat, electrical shock, and ultraviolet radiation. Before powering on or installing, read the instruction manual first. Follow the safety precautions for operation and pay attention to the warning signs on the instructions and equipment;
- Only professionals are allowed to install, operate, and maintain lighting fixtures, and strictly follow the procedures stated in the operating instructions.



- The eyes cannot directly look at the luminous object;
- Do not connect this device to any dimmer;
- If visible damage occurs to the protective casing, lens, and display screen on the lighting fixture, it is considered as damage to the point of loss;
- Please do not place any filters or other items at the light outlet, and do not replace non original parts;
- The minimum safe illumination distance of the lamp is 25m.



- Before installation, please confirm that the power supply voltage used matches the voltage indicated on the light fixture. Each lighting fixture should be properly grounded and electrically installed according to relevant standards;
- Please disconnect the power before repairing or cleaning the equipment;
- During the operation of the lighting fixtures, touching the wires is prohibited to prevent electric shock;
- If the external soft cable or wire of this lamp is damaged, the wire should be replaced by the manufacturer, its agent, or a similarly qualified person to avoid danger;
- Avoid flammable liquids, water, or metal conductors from entering the interior of the lamp to prevent electric shock or fire. If any foreign objects enter the lamp, immediately cut off the power supply;
- When multiple lamps are operated in series, the signal lines can be connected in multiple ways, but the power supply must be connected separately.



- The lighting fixtures work normally at -20 °C to 45 °C . When replacing any components or accessories in the equipment, ensure that the power is disconnected to prevent electric shock and injury;
- The maximum surface temperature of the lamp during operation can reach 61°C , please do not touch it with bare hands.



- The lighting fixtures must be installed in a sufficiently ventilated area, at least 0.5m away from adjacent surfaces, to ensure that no ventilation holes are blocked;
- Do not install the lighting fixtures directly on flammable objects;
- The minimum distance between all outer surfaces of the lamp and combustible materials is 0.5m.

2. Product Introduction

2.1 Exterior dimensions of lighting fixtures

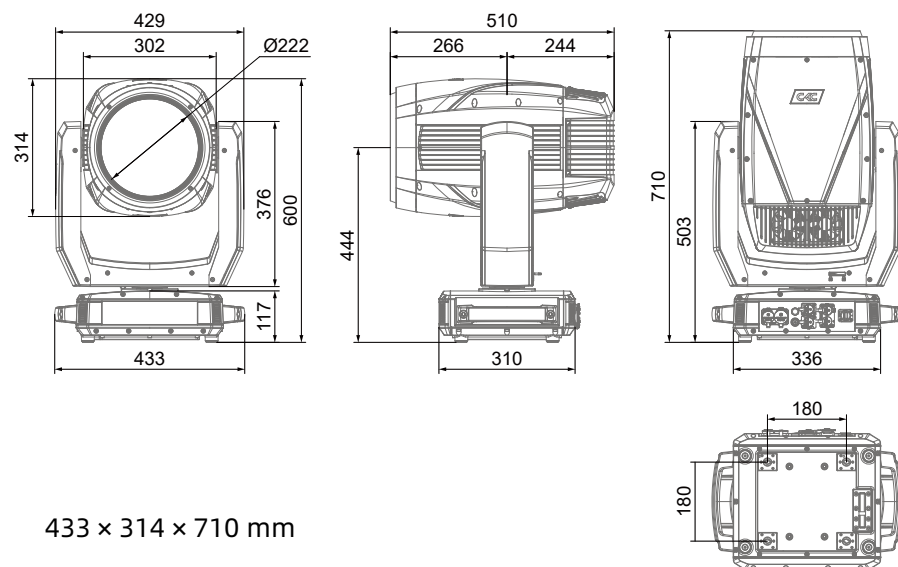

433 × 314 × 710 mm

2.2 Packaging accessories

Name	QTY
Omega bracket	2 PCS
Clamp	2 PCS
Safety cable	1 PCS

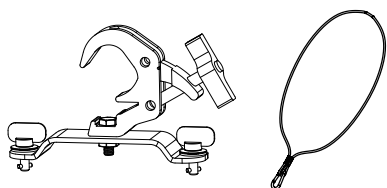

3. Main technical parameters of the equipment

Product execution standards: GB7000.1-2023, GB7000.217-2023, Q/YF-2017

● Electrical parameter

Rated input voltage: AC 100V-240V~ 50Hz/60Hz
 Rated power of the entire fixture: 430W
 Power factor: 0.997F
 Input Current: 1.829A 220V

● Source lifespan

>20000 hours

● Color system

CCT: 7800K
 Color wheel: 17+1
 Six-color Wheel
 CMY

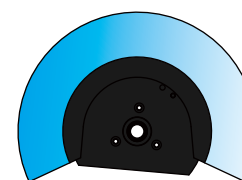
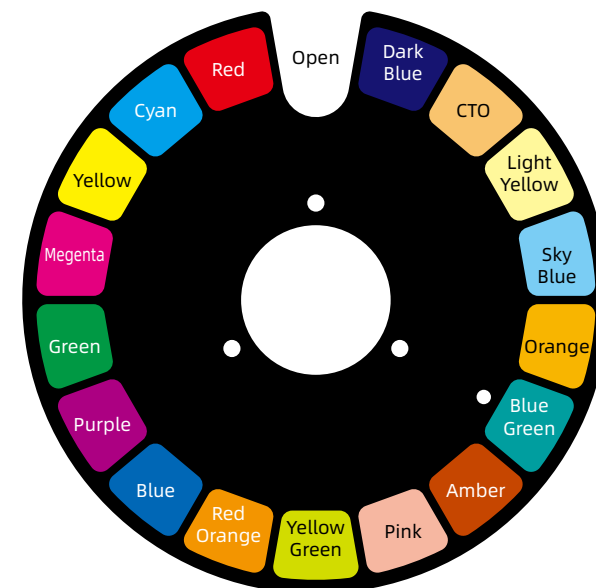
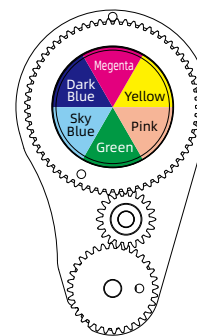

CYAN

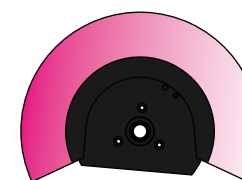

MAGENTA

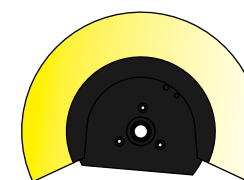

YELLOW

● Gobo system

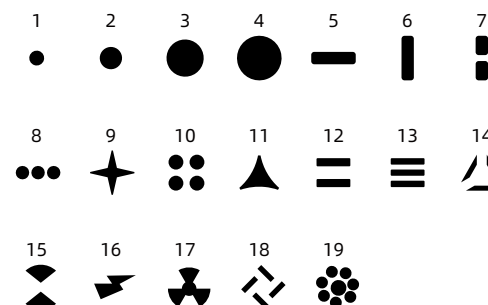
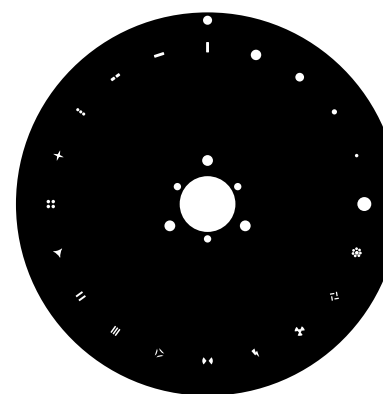

● Prism system

16 prism+ 6 linear+Kaleidoscopic Prism+8 prism

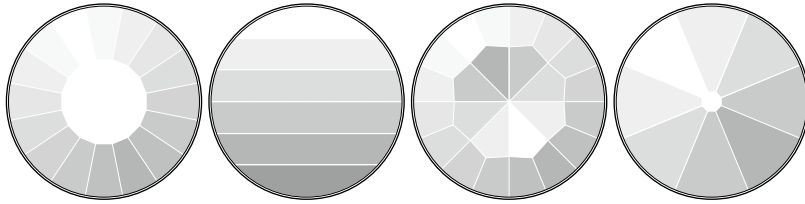

The 16 prism and the kaleidoscopic prism can be stacked with a 6 lens array or an 8 prism.

● Pan/Tilt

Pan scan:

540° or 630° 8-bit/16bit resolution scanning

Tilt scan:

270° 8-bit/16bit precision scanning

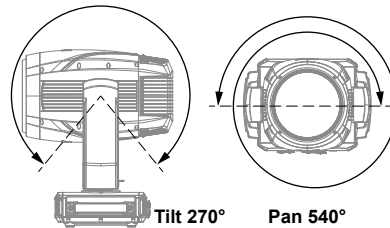

● Optical system

Beam angle: 0.8°

Source: 260W laser

Output luminous flux: 9400 Lm

Lux: 46200 Lux@20m

● Control and programming

Control channel: 22CH/30CH

Protocol: DMX512, RDM

Data connect: 3 or 5 pin signal in/out

● Illumination draw

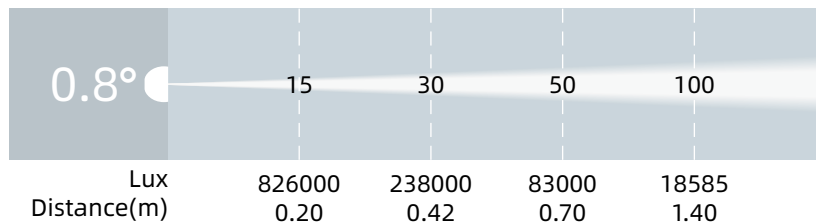

● Other effect function

Fast electronic strobe: 1~25Hz

Frost

● Other features and functions

Weight: 38.7 KG

4. Packaging and transportation

4.1 Disassemble packaging



Notice: After receiving the fixture, please unpack and check for any damage caused by transportation. If there is any damage caused by transportation, please do not use this fixture and contact the local technical personnel or manufacturer as soon as possible.

4.2 Equipment packaging

- 1). Disconnect the power supply before packaging the lighting fixtures to allow them to cool completely;
- 2). Flight cases can only be stacked in two layers and are not allowed to be reversed.

5. Installation Requirements Explanation

5.1 Clamp install

The lighting fixtures can be installed on the stage or on any direction of the truss, and the clamp can be quickly and easily locked onto the truss.

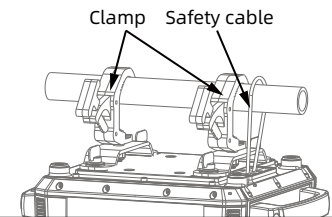

Warning !

The lighting fixtures are divided into two versions: integrated light hook and normal. When using the integrated light hook version, the clamp is broken up and locked onto the truss. The normal version must use 2 clamps to secure the device and fasten it with a 1/4 rotation. Regardless of the version, one safety rope must be added and connected to the base hole, but be careful not to connect it to the handling handle.

Quick lock and clamp install

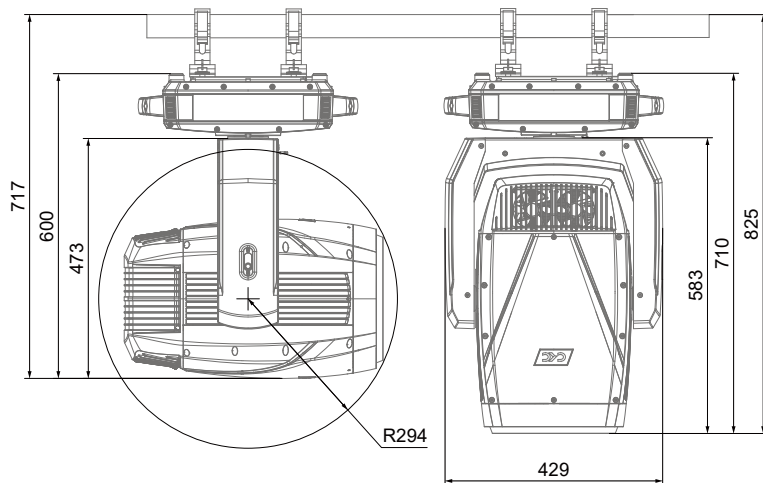
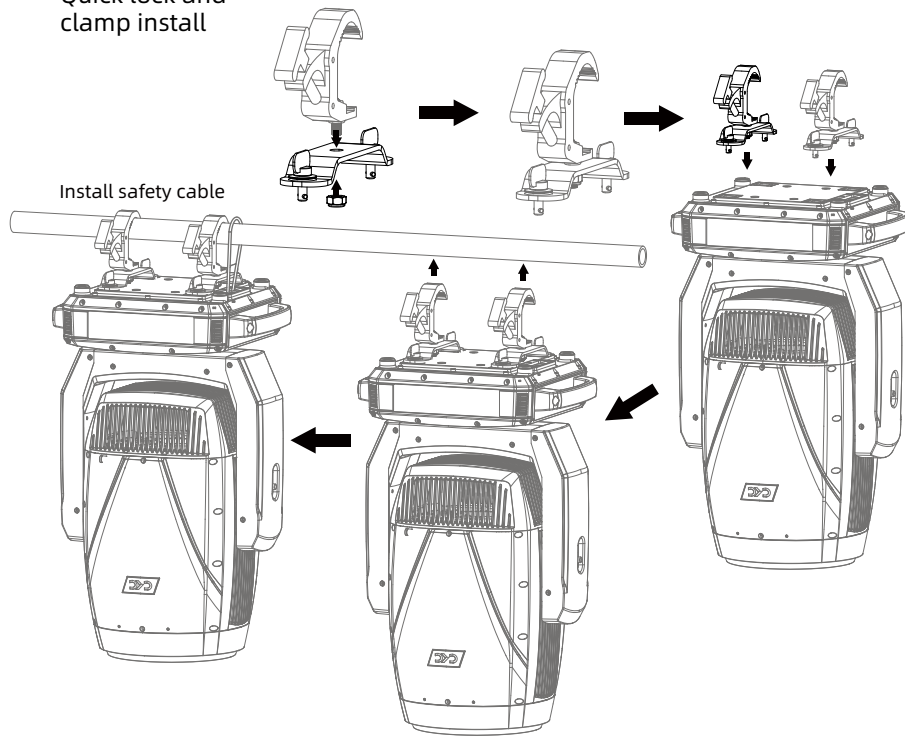

5.2 Equipment installation

- 1). Before installation, it is necessary to verify that the lamp hook and safety rope are not damaged, and that the installation object can withstand 6 times the total weight of the lamp and cable accessories;
- 2). Install the quick lock clamp on the base of the lamp body. Insert the clamp horizontally into the mounting hole of the base, rotate it clockwise 1/4 turn to lock it, and install the second clamp using the same method (the shape of the clamp should be based on the actual product).

5.3 Hanging Installation Diagram

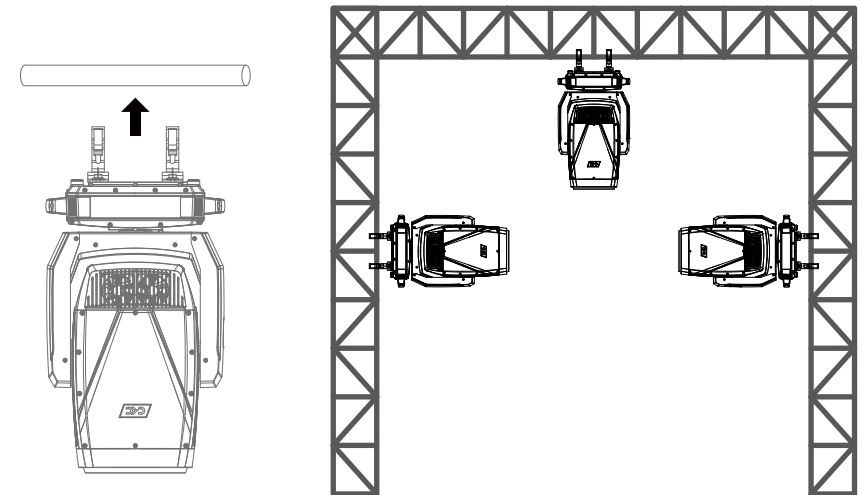

Reminder: External beam source may damage internal lighting fixtures

External beams from direct sunlight, lighting fixtures, and lasers that are directly focused onto the casing or penetrate the lens to illuminate the interior of the fixture may cause damage to the components. This is a common issue with all lighting fixtures and does not occur alone with CKC products. Although there is no way to completely prevent this problem from occurring, following the following guidelines can prevent potential damage.

When unpacking, installing, using, and stopping the operation of the lighting fixtures, please do not expose the transparency of the fixtures the mirror is exposed to direct sunlight, other lighting fixtures, or laser beams, Do not directly focus the beam of this device onto another lighting fixture.

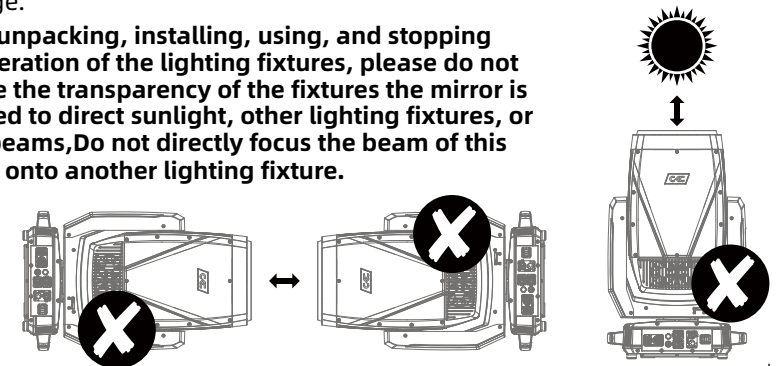

6. Power、Signal connect

6.1 Power and signal socket

- | | |
|--------------------|----------------|
| 1.Power input | 2.Power output |
| 3.Breathable valve | 4.Fuse holder |
| 5.DMX output | 6.DMX input |
| 7.DMX output | 8.DMX input |
| 9.USB | |

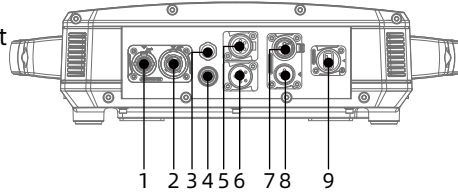

6.2 Power connect

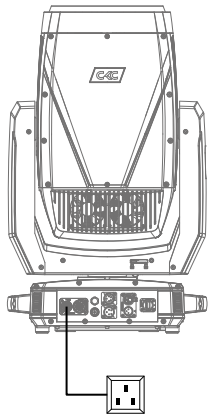

Connection method:

L(live wire) - brown wire

E(Ground wire) - yellow/green dual color line

N(Zero Line) - Blue Line

When connecting the power supply, please note that the voltage and frequency of the power supply must match the voltage and frequency marked on the light fixture. When multiple fixtures are used simultaneously, it is recommended to connect the power supply of each fixture separately, so that each fixture can be individually controlled for power on/off.



Attention: When connecting the power supply, the ground wire (yellow/green dual color wire) must be safely grounded and comply with all relevant electrical installation standards.



Power In

This product uses Powercon In/Out to connect power cable. Due to power limitations, a 2mm power cable can drive up to 5 fixtures at 220V.

Warning !

- Do not connect too many fixtures or overload a single power cord;
- Do not use power cords with damaged insulation layers, and do not place power cords on other wires;
- When the fixture is not in use or cleaned, please unplug the power cord; Do not forcefully unplug or drag the power cord directly.

6.3 Signal connect

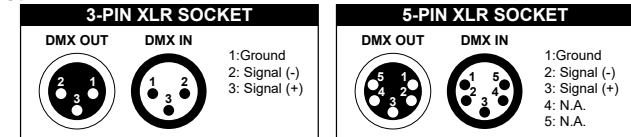

The lighting fixtures are equipped with standard DMX XLR input and output sockets. Please use DMX512 shielded twisted pair signal cables or Category 5 or above network twisted pair cables for connection. The typical connection distance for DMX signal lines is 150 meters. When transmitting signals over long distances, a DMX512 signal amplifier must be added.

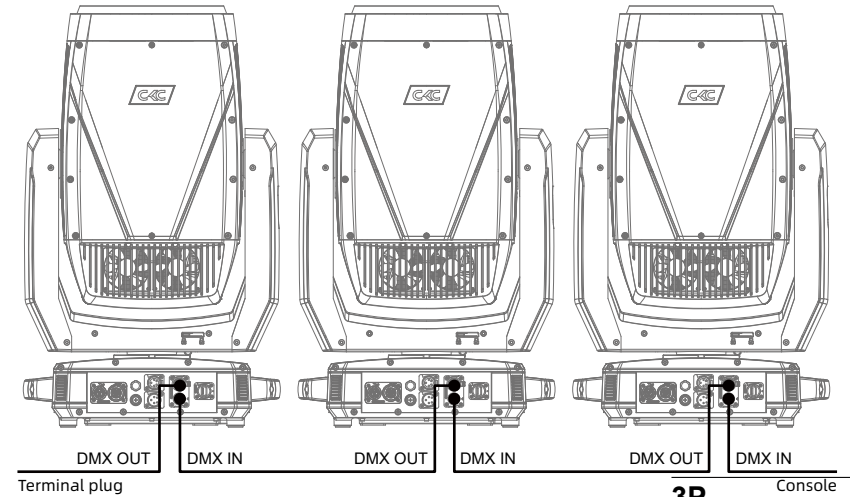

Connect a shielded twisted pair signal cable from the DMX output port of the controller to the DMX input port of the first device, and from the DMX output port of the first device to the DMX input port of the second device, and so on, until all the lamps are connected. Then install a terminal plug on the last 3 pin socket of each connected lamp output. (Weld a 4/1W, 120 Ω resistor between the 2 and 3 pins of a 3 or 5 core pin XLR plug).

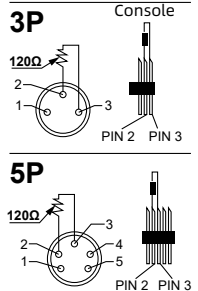

7. Control panel

7.1 Panel Introduction



- Adopting a 2.8 "LCD display screen, the operation panel is equipped with a rechargeable battery, which can enter the menu to set address codes and make other settings without powering on;
- Press the MODE key to view or modify the lighting function settings, and press the UP, DOWN, LEFT, and RIGHT keys to select the function menu;
- Press the ENTER key to confirm your selected function menu, which will take you to the corresponding sub menu in the menu. Each menu item represents a specific function of the lighting fixture (as shown in the table below);
- Press the ENTER key to save your modifications or enter a submenu, and press the UP or DOWN key to modify values (increase or decrease values); Press the MODE key to return to the previous menu or exit.
- Press the MODE key to return to the previous menu or exit.

7.2. System menu

Note: The gray color block is the default setting value

Software Update Please Wait... CKC Proxima IP Fixture Type Check Motor Reset...			
SET	Dmx Presets	A001~AXXX	
	User Mode	Standard Extend	
	Status	No DMX Mode	Black/Hold/Auto
		P.Reverse	ON/OFF
		T.Reverse	ON/OFF
		Pan Degree	630/540
		Feedback	ON/OFF
		Move.Speed	Speed 1~4
	Dim Mode	Hibernation	OFF, 01M~99M, 15M
		Standard	
		Stage	
		TV Architectural Theatre	
	Temp. C/F	Celsius	
		Fahrenheit	

Function	Dim Curve	Linear Square Inv-Square S-Curve	
	Frequency	900Hz/1000Hz/1100Hz/1200Hz/1300Hz/1400Hz/1500Hz/ 2500Hz/4000Hz/5000Hz/10KHz/15KHz/20KHz/25KHz	
	Fan Set	Head Fan	Auto High Low
		Base Fan	Auto High Low
	LCD.Set	Backlight Flip Display Key Lock DispFlash	01~60m OFF/ON OFF/ON OFF/ON
	Disp.Set	Channel Value Slave Set Auto.Prog	PAN..... Slave1,Slave2,Slave3 Master / Alone
	DFSE	OFF/ON	
Test	USB Update	OFF/ON	
	Reset.M	All Pan&Tilt Other	
	Test.Chan	PAN	
	Panel.Ctrl.	PAN =XXX :	
Info	Calibrate	-Password- PAN :	
	Time.Info	Current (Hours) Total Time (Hours) Last Time(Hours) Timer PIN (Password=50) Clear Last (ON/OFF)	
	Temp. Info	Base Temp. Head Temp.	
	Fan Speed	Base Fan1:xxxx RPM Base Fan2: xxxx RPM Cool Fan1: xxxx RPM	
	Error. Info	Pan,Tilt.....	
	Model. Info	Proxima IP	
	Software.V	1U V 1.X.X 2U V 1.X.X 3U V 1.X.X :	

8. DMX channel table:

Mode/Channel		Values	Traits
St	Ex		
1	1	000~255	PAN Movement 8-bit: Pan Movement By 630/540
2	2	000~255	Pan Fine 16-bit: Fine control of Pan movement
3	3	000~255	TILT Movement 8-bit: Tilt Movement
4	4	000~255	Tilt Fine 16-bit: Fine control of Tilt movement
5	5	000~255	Dimmer (intensity): Intensity 0 to 100%
6	6	000~255	Dimmer Fine 16-bit: Intensity 0 to 100%
7	7		Shutter, strobe:
		000~031	No function (shutter closed)
		032~063	Shutter open
		064~095	Strobe slow to fast
		096~127	Shutter open
		128~159	Slow to fast pulse effect
		160~191	Shutter open
		192~223	Slow to fast random strobe
		224~255	Shutter open
8	8	000~255	Cyan: 0 to 100%
	9	000~255	Cyan Fine: 0 to 100%
9	10	000~255	Magenta: 0 to 100%
	11	000~255	Magenta Fine: 0 to 100%
10	12	000~255	Yellow: 0 to 100%
	13	000~255	Yellow Fine: 0 to 100%
			Color Wheel 1:
		000~005	Color 0(open)
		006~009	Color 1
		010~013	Color 2
		014~017	Color 3
		018~021	Color 4
		022~025	Color 5

11	14	026~029	Color 6
		030~033	Color 7
		034~037	Color 8
		038~041	Color 9
		042~045	Color 10
		046~049	Color 11
		050~053	Color 12
		054~057	Color 13
		058~061	Color 14
		062~065	Color 15
		066~069	Color 16
		070~073	Color 17
		074~079	Color 0-1
		080~085	Color 1-2
		086~091	Color 2-3
		092~097	Color 3-4
		098~103	Color 4-5
		104~109	Color 5-6
		110~115	Color 6-7
		116~121	Color 7-8
		122~127	Color 8-9
		128~133	Color 9-10
		134~139	Color 10-11
		140~145	Color 11-12
		146~151	Color 12-13
		152~157	Color 13-14
		158~163	Color 14-15
		164~169	Color 15-16
		170~175	Color 16-17
		176~181	Color 17-0
		182~213	Clockwise from fast to slow
		214~223	No rotation
		224~255	Counter-clockwise from slow to fast
			Fixed Gobo, cont. rotation:
		000~005	Gobo 0(Open)
		006~010	Gobo 1
		011~015	Gobo 2
		016~020	Gobo 3
		021~025	Gobo 4
		026~030	Gobo 5
		031~035	Gobo 6

12	15	036~040	Gobo 7
		041~045	Gobo 8
		046~050	Gobo 9
		051~055	Gobo 10
		056~060	Gobo 11
		061~065	Gobo 12
		066~070	Gobo 13
		071~075	Gobo 14
		076~080	Gobo 15
		081~085	Gobo 16
		086~090	Gobo 17
		091~095	Gobo 18
		096~100	Gobo 19
		101~105	Gobo 1 shake, from slow to fast
		106~110	Gobo 2 shake, from slow to fast
		111~115	Gobo 3 shake, from slow to fast
		116~120	Gobo 4 shake, from slow to fast
		121~125	Gobo 5 shake, from slow to fast
		126~130	Gobo 6 shake, from slow to fast
		131~135	Gobo 7 shake, from slow to fast
		136~140	Gobo 8 shake, from slow to fast
		141~145	Gobo 9 shake, from slow to fast
		146~150	Gobo 10 shake, from slow to fast
		151~155	Gobo 11 shake, from slow to fast
		156~160	Gobo 12 shake, from slow to fast
		161~165	Gobo 13 shake, from slow to fast
		166~170	Gobo 14 shake, from slow to fast
		171~175	Gobo 15 shake, from slow to fast
		176~180	Gobo 16 shake, from slow to fast
		181~185	Gobo 17 shake, from slow to fast
		186~190	Gobo 18 shake, from slow to fast
		191~195	Gobo 19 shake, from slow to fast
		196~224	Clockwise from fast to slow
		225~226	No rotation
		227~255	Counter-clockwise from slow to fast
13	16		Prism 1 & 2:
		000~005	Open
		006~127	Prism 1
		128~255	Prism 2

14	17		Prism 1 & 2 Indexing and Rotation:
		000~005	Open
		006~128	Prism1 & 2 indexing
		129~191	Forwards prism1 & 2 rotation from fast to slow
		192~192	No rotation
	18	193~255	Backwards prism1 & 2 rotation from slow to fast
		000~255	Prism 1 & 2 Fine Indexing (16-bit): Fine control of Prism 1 & 2 Indexing movement
15	19		Prism 3 & 4:
		000~005	No function
		006~127	Prism3
		128~255	Prism4
16	20		Prism 3 & 4 Indexing and Rotation:
		000~005	Open
		006~128	Prism3 & 4 indexing
		129~191	Forwards prism3 & 4 rotation from fast to slow
		192~192	No rotation
	21	193~255	Backwards prism3 & 4 rotation from slow to fast
		000~255	Prism 3 & 4 Fine Indexing (16-bit): Fine control of Prism 3 & 4 Indexing movement
17	22		Split Color:
		000~005	Nofunction
		006~255	Split Color
18	23		Split Color Indexing and Rotation:
		000~127	Split Color indexing
		128~189	Forwards rotation from Fast -> Slow, CW
		190~193	No rotation
		194~255	Backwards rotation slow -> fast
	24	000~255	Split Color Fine Indexing (16-bit): Fine control of Split Color Indexing movement
		000~255	Focus: Continuous adjustment from far to near
19	25	000~255	Focus Fine: Continuous adjustment from far to near
		000~255	Frost : 0 to 100%
20	27		Dim Modes:
		000~020	Standard
		021~040	Stage
		041~060	TV
		061~080	Architectural
		081~100	Theatre

		101~255	Default to Unit Setting
29	000~255	Pan/Tilt Speed: Max to min speed	
		Function Device Set:	
	000~005	No function	
	006~017	Invert Pan on	
	018~029	Invert Pan off	
	030~041	Invert Tilt on	
	042~053	Invert Tilt off	
	054~061	Fan Auto	
	062~069	Fan Silent	
	070~077	Fan High	
	078~089	Linear	
	090~101	Square	
	102~113	Inv-S	
	114~125	S-Cure	
22	30	126~131	900hz
		132~137	1000hz
		138~143	1100hz
		144~149	1200hz
		150~155	1300hz
		156~161	1400hz
		162~167	1500hz
		168~173	2500hz
		174~179	4000hz
		180~185	5000hz
		186~191	10khz
		192~197	15khz
		198~203	20khz
		204~209	25khz
		210~221	P/TReset
		222~233	Head Reset
		234~255	All Reset

9. Control circuit diagram

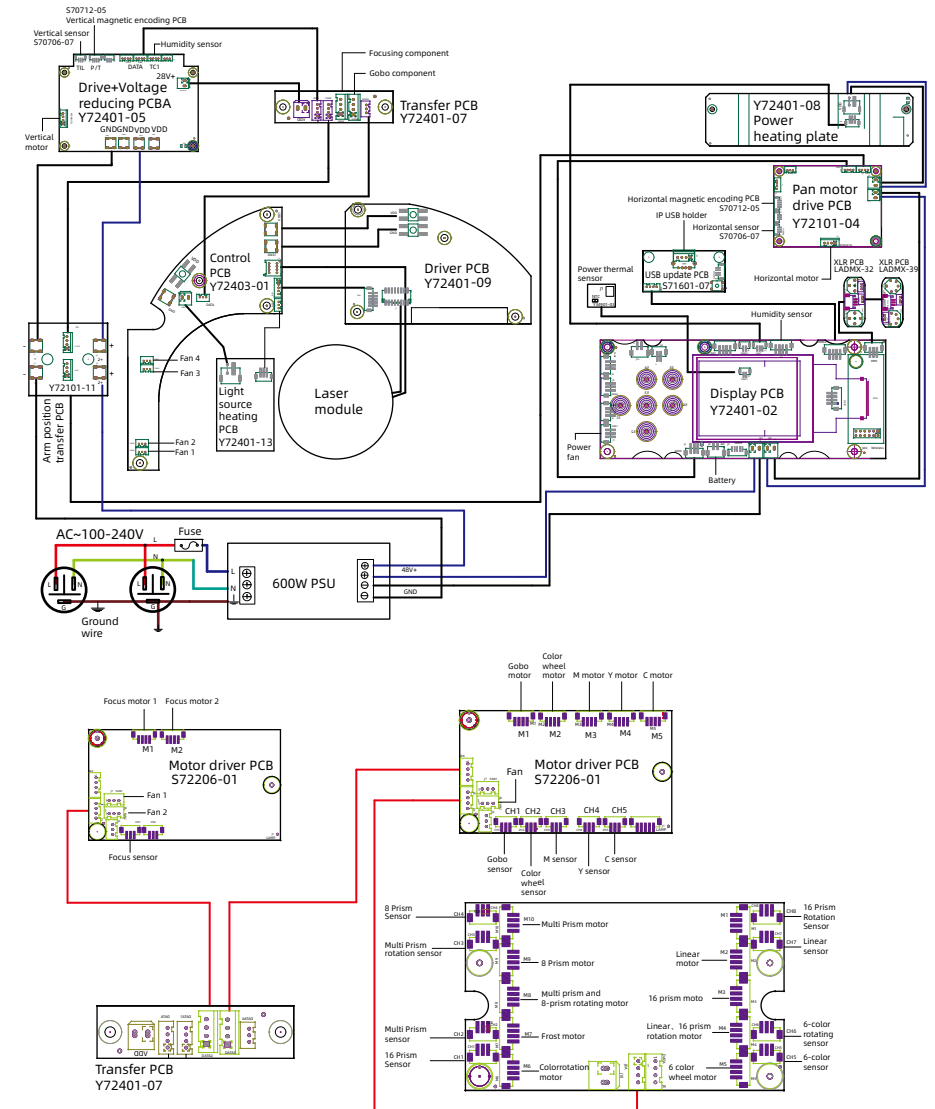

10. Regular maintenance

10.1 Cleaning and maintenance

Lighting fixtures require daily cleaning and maintenance, and their service life largely depends on the operating environment and standards. If you have any questions, please consult our technical engineers for advice. Maintenance and repair work not included in this book should be entrusted to our qualified technical engineers.



Attention! Damage caused by dust, e-liquid, or other reasons, as well as abnormal use, is not covered by the warranty.



Warning !

Before opening any lid, disconnect the power supply. Cleaning optical components requires gentle wiping as the coating surface is prone to scratching. Do not use damaging liquids or hard objects, as they may damage the plastic or coating surface.

- When the lens is cracked or otherwise damaged, it should be replaced in a timely manner;
- When the brightness significantly decreases, the LED may have reached its expiration date and should be replaced in a timely manner;
- When the fixture cannot start, please check if the fixture power fuse is blown. If it is blown, a fuse of the same specification must be used for installation;
- The fixture is equipped with a temperature protection device. When the temperature is too high, the protection device will automatically reduce power.
- When this situation occurs, please check whether the fan is running normally, whether the fan and fan mesh are clogged with dust, identify the fault and repair it before starting the fixture. Please note that only qualified technicians are allowed to carry out maintenance work;
- To maintain smooth movement of the focusing lens, it is recommended to lubricate the guide rail of the focusing lens every three months. Excellent and high-temperature resistant lubricating grease should be used, and excessive grease should not be used as it can easily dirty adjacent components.

10.2 Fault analysis and handling

Fault description	Analysis	Processing method
No action after power on	Check if the power switch is turned on	Turn on
	Check if the fuse is blown	Replace
	Check if the output of PSU is normal	Detecting voltage
	Check if poor contact in the internal circuit	Reconnect

Uncontrolled lighting fixtures	Check if the DMX signal cable is connected correctly (If there is no signal, the display screen will flash)	Reconnect or replace
	Check if the address code is correct and if the DMX mode of the lighting fixture matches the settings	Reconfirm
	The main control PCB is damaged	Replace
Not bright	LED aging or damage	Replace
	Power PCB malfunction	Check/ Replace
	Loose or poor contact of the circuit	Reconnect
Automatically turn off or dim the lights	PSU malfunction	Replace
	LED aging	Replace
	Damaged cooling fan or abnormal wind speed	Replace
	Check the power output of the fan	Check/ Replace
Gobo wheel misalignment or abnormal control	The temperature control switch is damaged	Replace
	Poor contact of motor wire	Reconnect
	Corresponding motor drive board malfunction	Refixed
	Misalignment or magnetic damage between the magnetic tube and the positioning magnet	Adjust/Replace
Weak light efficiency and uneven light spot	Motor malfunction	Replace
	LED aging	Replace
	LED not centered with the lens	Adjust LED
	The optical mirror has accumulated dust or stains	Clean
Impure color	The optical mirror is damaged	Replace
	Weakening of light efficiency	Replace led PCB
	The color filter has accumulated dust or stains	Clean
	The color filter has been demolded or damaged	Replace

Gobo is unclear	The optical mirror has accumulated dust or stains	Clean
	The optical mirror is damaged	Replace
Head or base fan stops rotating	Check if the fan leads are installed properly or disconnected	Re connect
	Check if the fan is damaged	Replace
	Check if there are any other interfering objects within the operating range of the fan	Adjust
 Attention! The above analysis is for abnormal reference only. Non professionals are not allowed to disassemble and repair the machine		

