

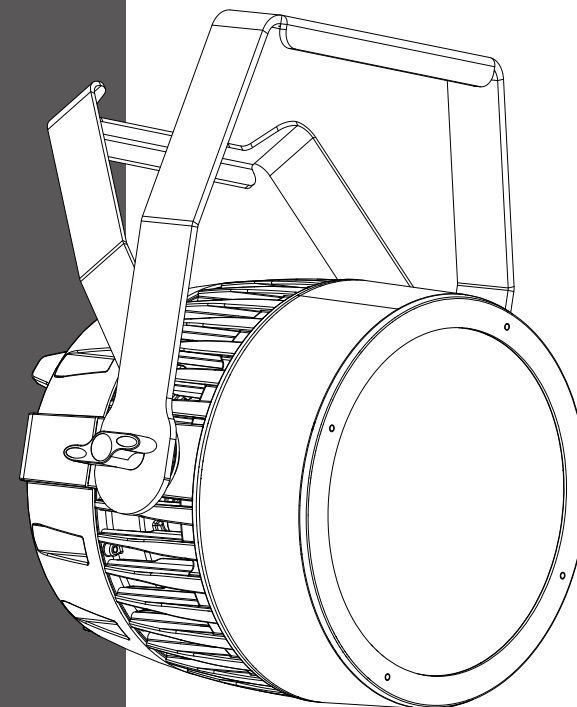

PAR Z180 IP



CKC LIGHTING CO.,LTD

Addr.:335 Nansha Avenue, Tung Chung Town,
Nansha District, Guangzhou City, China.
TEL: (020)3920 4506 FAX: (020)3920 4631
WEB: www.ckclighting.com

www.ckclighting.com



Before carrying out any installation, maintenance, or cleaning of the lighting fixtures, please confirm that the power has been cut off! Before using this fixture, please read this manual. Our company reserves the right to change product design and specifications without prior notice.

CONTENTS

1. Security Warning Information	1
2. Product Introduction	3
2.1 Exterior dimensions	3
2.2 Fixture packaging accessories	3
3. Main technical parameters of the equipment	3
4. Packaging and transportation	4
4.1 Disassemble packaging	4
4.2 Equipment installation	5
5. Installation Requirements Explanation	5
5.1 Clamp installation	5
5.2 Fixture installtion	6
5.3 Hanging Installation Diagram	6
6. Power and signal connection	6
6.1 Power and signal socket	6
6.2 Power Connect	7
6.3 Signal Connect	7
7. Control panel	8
7.1 Panel Introduction	8
7.2 System menu	9
8. DMX control channel table	10
9. Control circuit diagram	17
10. Regular maintenance	17
10.1 Cleaning and maintenance	17
10.2 Fault analysis and handling	18

★ Statement ★

- This manual contains important information on safe use and installation. Please read it carefully and follow the requirements for operation and installation. Please keep this manual properly;
- The equipment has good performance and complete packaging when it leaves the factory. The operator should strictly follow the warning items and operating instructions stated in the manual. Any malfunction or damage caused by misuse or neglect of the manual is not within the scope of our company's responsibility and warranty;
- The relevant information in this manual is for reference only. All lighting products are subject to the actual product. Any changes will not be notified separately, and our company reserves the right of final interpretation.

1. Security Warning Information



Attention !

Please read the safety requirements information in this section carefully before installing, powering on, operating, or repairing the lighting fixtures.



- This product is for professional use and is not suitable for other purposes;
- After receiving the lighting fixtures, please check if the packaging is complete and unpack to check if the equipment has been damaged due to transportation. If there is any damage caused by transportation, please do not use this lamp and contact local technicians or manufacturers as soon as possible;
- When transporting again, please use the original packaging materials;
- If there is obvious damage to the machine casing, it should be replaced in a timely manner;
- When hanging lamps, it is necessary to verify that the hanging equipment can withstand more than 6 times the weight of the lamp. After installation, it is necessary to verify that the lamp cover and installation buckle are secure and undamaged. At the same time, a safety rope should be used as an auxiliary safety for the lamp and fixed on the truss;
- The light source inside this luminaire should be replaced by the manufacturer, its service agent, or a similarly qualified person;
- If you have any other questions about how to safely operate the equipment, please contact our technical personnel or call our service hotline;
- This product has a protection level of IP65 and can be used both indoors and outdoors;



- Lighting fixtures should be kept clean and avoid prolonged use in overheated or dusty environments to prevent contact with chemical liquids;
- When using the product, attention should be paid to avoiding serious or fatal injuries caused by fire, heat, electrical shock, and ultraviolet radiation. Before powering on or installing, read the instruction manual first. Follow the safety precautions for operation and pay attention to the warning signs on the instructions and equipment;
- Only professionals are allowed to install, operate, and maintain lighting fixtures, and strictly follow the procedures stated in the operating instructions.



- The eyes cannot directly look at the luminous object;
- Do not connect this device to any dimmer;
- If visible damage occurs to the protective casing, lens, and display screen on the lighting fixture, it is considered as damage to the point of loss;
- Please do not place any filters or other items at the light outlet, and do not replace non original parts;
- The minimum safe illumination distance of the lamp is 1m.



- Before installation, please confirm that the power supply voltage used matches the voltage indicated on the light fixture. Each lighting fixture should be properly grounded and electrically installed according to relevant standards;
- Please disconnect the power before repairing or cleaning the equipment;
- During the operation of the lighting fixtures, touching the wires is prohibited to prevent electric shock;
- If the external soft cable or wire of this lamp is damaged, the wire should be replaced by the manufacturer, its agent, or a similarly qualified person to avoid danger;
- Avoid flammable liquids, water, or metal conductors from entering the interior of the lamp to prevent electric shock or fire. If any foreign objects enter the lamp, immediately cut off the power supply;
- When multiple lamps are operated in series, the signal lines can be connected in multiple ways, but the power supply must be connected separately.



- The lighting fixtures work normally at -20 °C to 45 °C . When replacing any components or accessories in the equipment, ensure that the power is disconnected to prevent electric shock and injury;
- The maximum surface temperature of the lamp during operation can reach 72 °C , please do not touch it with bare hands.



- The lighting fixtures must be installed in a sufficiently ventilated area, at least 0.5m away from adjacent surfaces, to ensure that no ventilation holes are blocked;
- Do not install the lighting fixtures directly on flammable objects;
- The minimum distance between all outer surfaces of the lamp and combustible materials is 0.5m.

2. Product Introduction

2.1 Exterior dimensions of lighting fixtures

333 × 259 × 389 mm

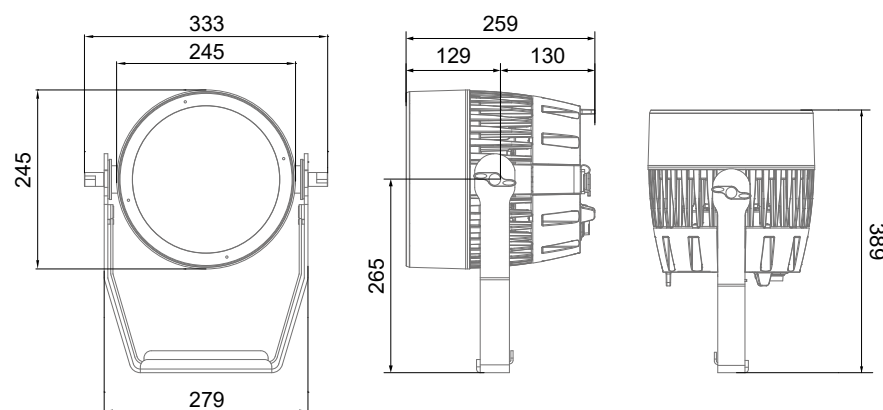

2.2 Packaging accessories

Name	QTY
Clamp	1 PCS
Safety cable	1 PCS

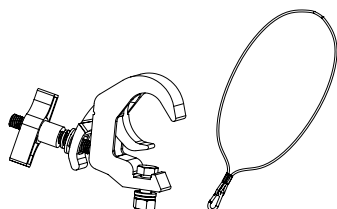

3. Main technical parameters of the equipment

Product execution standards: GB7000.1-2023, GB7000.217-2023, Q/YF-2017

● Electrical parameter

Rated input voltage: AC 100V~240V~ 50Hz/60Hz
 Rated power: 207 W
 Power factor: 0.97F
 Input Current: 1.07A 220V

● Source lifespan

> 20000 hours

● Optical system

Source: 180W RGBL LED
 Beam angel: 11 ~ 40°
 Field angle: 21 ~ 57°

● Control and programming

Control channel: 6CH/9CH/14CH
 Protocol: DMX512, RDM
 Data connect: 3 pin or 5pin signal in/out

● Illumination draw

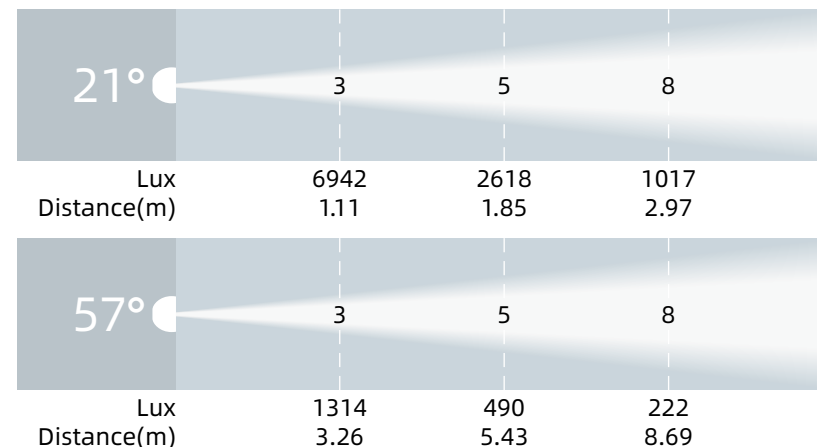

● Other effect function

Fast electronic strobe: 1~25Hz Built in effects: 7 kinds

● Other features and functions

Weight: 8.4 KG

4. Packaging and transportation

4.1 Disassemble packaging



Notice: After receiving the fixture, please unpack and check for any damage caused by transportation. If there is any damage caused by transportation, please do not use this fixture and contact the local technical personnel or manufacturer as soon as possible.

4.2 Equipment packaging

- 1). Disconnect the power supply before packaging the lighting fixtures to allow them to cool completely;
- 2). Flight cases can only be stacked in two layers and are not allowed to be reversed.

5. Installation Requirements Explanation

5.1 Clamp install

The lighting fixtures can be installed on the stage or on any direction of the truss, and the clamp can be quickly and easily locked onto the truss.

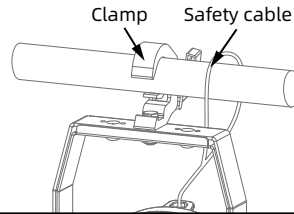

Warning !

Fixture can be used to fix the equipment, and a safety rope must be connected to the safety hook. Note that it cannot be connected to the handle.

Quick lock and clamp install

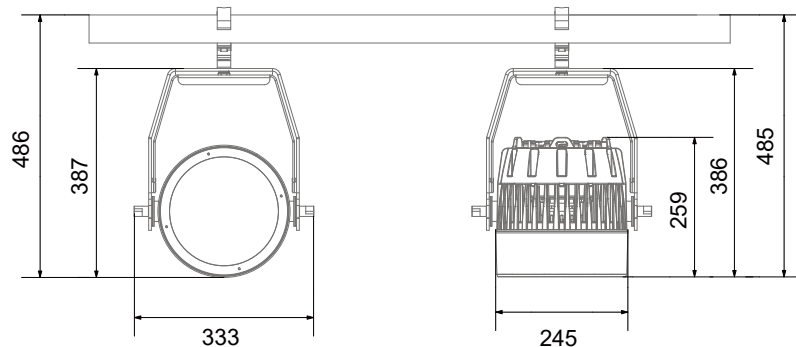
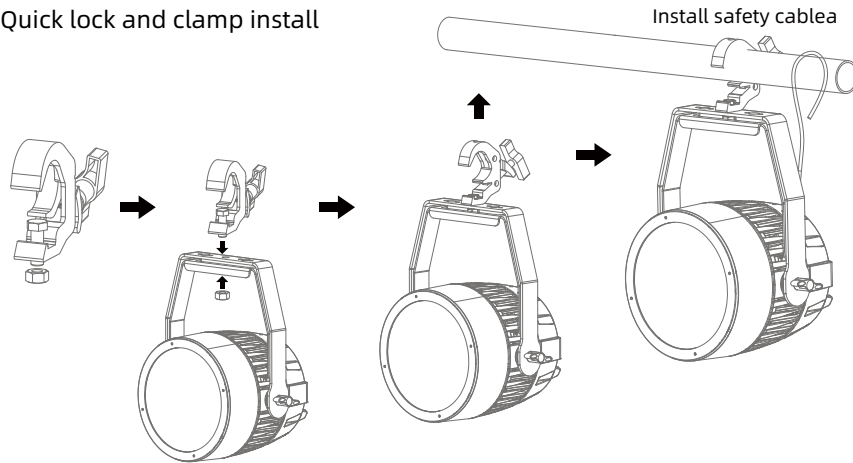

5.2 Equipment installation

- 1). Before installation, it is necessary to verify that the lamp hook and safety rope are not damaged, and that the installation object can withstand 6 times the total weight of the lamp and cable accessories;
- 2). Install the lamp hook on the handle and insert it horizontally into the handle mounting hole to lock it in place.

5.3 Hanging Installation Diagram

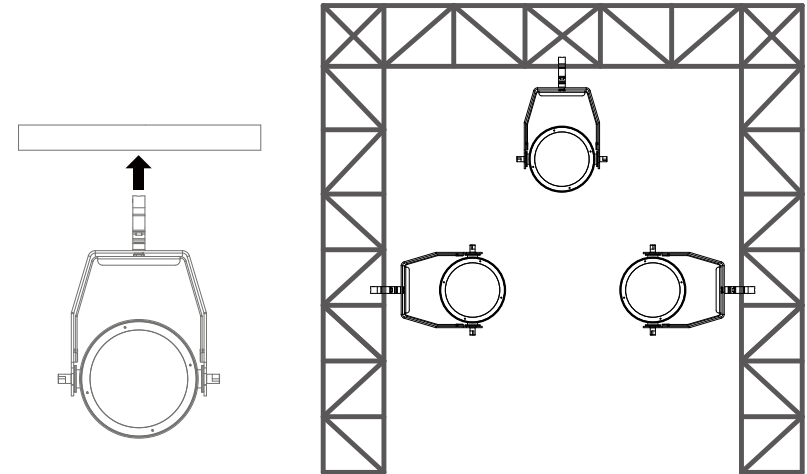

6. Power、Signal connect

6.1 Power and signal socket

1. 3P DMX input
2. 5P DMX input
3. Power input
4. 5P DMX output
5. 3P DMX output
6. Power output

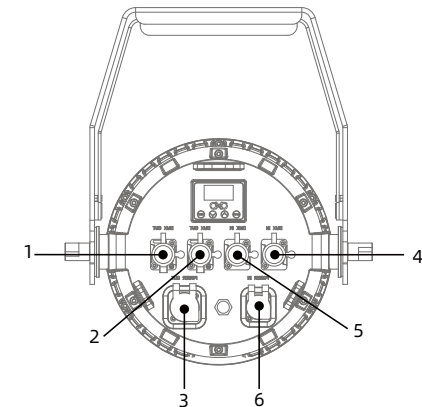

6.2 Power connect

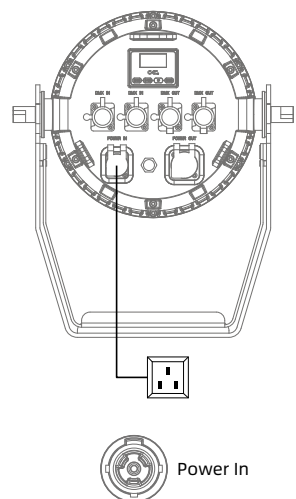

Connection method:

L(live wire) - brown wire

E(Ground wire) - yellow/green dual color line

N(Zero Line) - Blue Line

When connecting the power supply, please note that the voltage and frequency of the power supply must match the voltage and frequency marked on the light fixture. When multiple fixtures are used simultaneously, it is recommended to connect the power supply of each fixture separately, so that each fixture can be individually controlled for power on/off.



Attention: When connecting the power supply, the ground wire (yellow/green dual color wire) must be safely grounded and comply with all relevant electrical installation standards.

This product uses Powercon In/Out to connect power cords. Due to power limitations, a 2 square meter power cord can carry up to 9 products at 220V and 4 product at 110V.

Warning !

- Do not connect too many fixtures or overload a single power cord;
- Do not use power cords with damaged insulation layers, and do not place power cords on other wires;
- When the fixture is not in use or cleaned, please unplug the power cord; Do not forcefully unplug or drag the power cord directly.

6.3 Signal connect

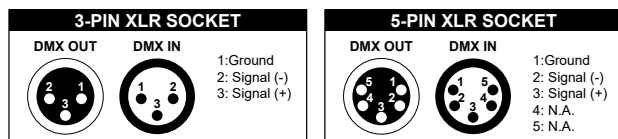

The lighting fixtures are equipped with standard DMX XLR input and output sockets. Please use DMX512 shielded twisted pair signal cables or Category 3/5 or above network twisted pair cables for connection. The typical connection distance for DMX signal lines is 150 meters. When transmitting signals over long distances, a DMX512 signal amplifier must be added.

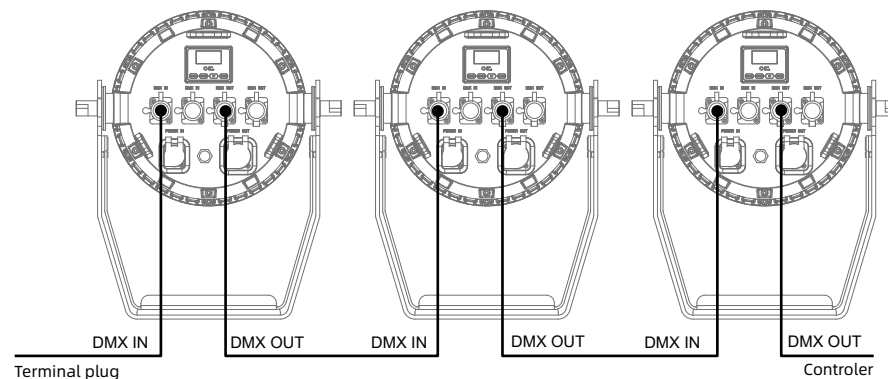

Connect a shielded twisted pair signal cable from the DMX output port of the controller to the DMX input port of the first device, and from the DMX output port of the first device to the DMX input port of the second device, and so on, until all the lamps are connected. Then install a terminal plug on the last 3 pin socket of each connected lamp output. (Weld a 4/1W, 120 Ω resistor between the 2 and 3 pins of a 3 or 5 core pin XLR plug).

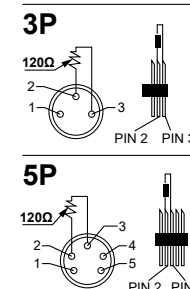

7. Control panel

7.1 Panel Introduction

- Adopting OLED screen display;
- Press the MODE key to view or modify the lighting function settings, and press the UP, DOWN, LEFT, and RIGHT keys to select the function menu;
- Press the ENTER key to confirm your selected function menu, which will take you to the corresponding sub menu in the menu. Each menu item represents a specific function of the lighting fixture (as shown in the table below);
- Press the ENTER key to save your modifications or enter a submenu, and press the UP or DOWN key to modify values (increase or decrease values); Press the MODE key to return to the previous menu or exit.
- Press the MODE key to return to the previous menu or exit.

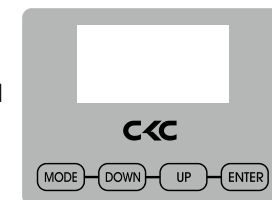

7.2. System menu

Note: The gray color block is the default setting value

CKC COLORZOOM 180 V1.06			
1-DMX ADDR	1-DMX 001	001-507	
2-DMX MODE	DMX MODE 14 CH	06 CH / 09 CH / 14 CH	
3-MANUAL MODE	DIMMER 255	000-255	
	RED 255	000-255	
	GREEN 255	000-255	
	BLUE 255	000-255	
	WHITE 255	000-255	
	SHUTTER 255	000-255	
	ZOOM 255	000-255	
4-MACRO MODE	MCDIMMER 255	000-255	
	MACRO 01	01 - 54	Pls find the below macro list
	MC SPEED 01	01 - 99	
	MC ZOOM 255	000-255	
5-SLAVE MODE	SLAVE MODE ON	ON - OFF	
6-SETUP	FAN MODE	FAN MODE AUTO	Auto/Studio
	DIM CURVE	DIM CURVE 000	000/ 001 / 002 / 003 / 004
	NO DMX	NO DMX HOLD	Hold / Blackout / Macro
	DISPLAY	BACKLIGHT 05 MIN	10s / 30s / 01min / 05 min / NEVER
		KEY LOCK ON	ON1/ON/OFF
		DP FLASH ON	ON/OFF
	RESET DEFAULT	DEFAULT OFF	ON/OFF
	ZOOM RESET	ZM RESET OFF	ON/OFF
	TEMP UNIT	TEMPUNIT FAREN	FAREN / CELSIUS
	ZOOM CAL	ZM CAL 000	000-255 (Password:050)

7-INFO	TIME INFO	CURRENT 0001 H	0 - 9999 H
		CUR CLEAR OFF	ON / OFF (Password:050)
		TOTAL 0001 H	0 - 9999 H
	TEMP INFO	TEMP INFO 000 ° C	
		TEMP MAX 000° C	
	MODEL	CKC COLORZOOM 180	000-255
	SOFTWARE	1U V106	
		2U V106	

8. DMX channel table:

MODE 6 CHANNELS		
Channel	Value	Function
1	Dimmer	
	000 - 255	Intensity 0 to 100%
2	Red	
	000 - 255	000 : Black out - 255 : red 100%
3	Green	
	000 - 255	000 : Black out - 255 : green 100%
4	Blue	
	000 - 255	000 : Black out - 255 : blue 100%
5	White	
	000 - 255	000 : Black out - 255 : white 100%
6	Zoom	
	000 - 255	Beam to wash
MODE 9 CHANNELS		
Channel	Value	Function
1	Dimmer	
	000 - 255	Intensity 0 to 100%
2	Red	
	000 - 255	000 : Black out - 255 : red 100%
3	Green	
	000 - 255	000 : Black out - 255 : green 100%
4	Blue	
	000 - 255	000 : Black out - 255 : blue 100%
5	White	
	000 - 255	000 : Black out - 255 : white 100%

6	Shutter	
	000 - 010	LED off
	011 - 020	LED on
	021 - 080	Strobe effect slow to fast
	081 - 090	LED on
	091 - 150	Pulse-effect in sequences
	151 - 160	LED on
	161 - 220	Random strobe effect slow to fast
	221 - 230	Reset Zoom after 5s
	231 - 255	LED on
7	Color and Macro	
	000 - 004	no function
	005 - 008	White 2700K
	009 - 016	White 3200K
	017 - 020	White 3500K
	021 - 024	White 4000K
	025 - 028	White 4500K
	029 - 032	White 5000K
	033 - 036	White 6000K
	037 - 040	White 6500K
	041 - 044	White 7000K
	045 - 048	White 7500K
	049 - 052	White 8000K
	053 - 056	Mauve 126
	057 - 060	Ultimate Violet 707
	061 - 064	Dark Lavender 180
	065 - 068	Cold Lavender 703
	069 - 072	Light Lavender 052
	073 - 076	Midnight Maya 508
	077 - 080	Tokyo Blue 071
	081 - 084	Zenith Blue 195
	085 - 088	Elysian Blue 714
	089 - 092	Just Blue 079
	093 - 096	Sky Blue 068
	097 - 100	Medium Blue 132
	101 - 104	Glacier Blue 352
	105 - 108	Steel Blue 117
	109 - 112	Lagon Blue 172
	113 - 116	Peacock Blue 115
	117 - 120	Jade 323
	121 - 124	Dark Yellow Green 090
	125 - 128	Lee Green 121
	129 - 132	Fern Green 122
	133 - 136	Moss Green 089
	137 - 140	Sally Green 505
	141 - 144	Ice and a Slice 513
	145 - 148	Light Amber 102
	149 - 152	Surprise Peach 017

	153 - 156	Dark Salmon 008	
	157 - 160	Madge 507	
	161 - 164	Light Red 182	
	165 - 168	Scarlet 024	
	169 - 172	Pink 157	
	173 - 176	Rose Pink 002	
	177 - 180	Magical Magenta 795	
	181 - 184	Bright Pink 128	
	185 - 188	Magenta 113	
	189 - 192	Lavender Tint 003	
	193 - 200	Fade Macro 1 to 12	
	201 - 209	Fade Macro 13 to 47	
	210 - 218	Fade Macro 13 to 18	
	219 - 227	Fade Macro 19 to 29	
	228 - 236	Fade Macro 30 to 34	
	237 - 245	Fade Macro 35 to 41	
	246 - 255	Fade Macro 42 to 47	
8	Speed		
	000 - 255	slow to fast	(Only can be use in CH7 193~255)
9	Zoom		
	000 - 255	Beam to wash	
MODE 14 CHANNELS			
Channel	Value	Function	
1	Dimmer		
	000 - 255	Intensity 0 to 100%	
2	Dimmer fine		
	000 - 255	ntensity 0 to 100%	
3	Red		
	000 - 255	000 : Black out - 255 : red 100%	
4	Red fine		
	000 - 255	000 : Black out - 255 : red 100%	
5	Green		
	000 - 255	000 : Black out - 255 : green 100%	
6	Green fine		
	000 - 255	000 : Black out - 255 : green 100%	
7	Blue		
	000 - 255	000 : Black out - 255 : blue 100%	
8	Blue fine		
	000 - 255	000 : Black out - 255 : blue 100%	
9	White		
	000 - 255	000 : Black out - 255 : white 100%	
10	White fine		
	000 - 255	000 : Black out - 255 : white 100%	

11	Shutter	
	000 - 010	LED off
	011 - 020	LED on
	021 - 080	Strobe effect slow to fast
	081 - 090	LED on
	091 - 150	Pulse-effect in sequences
	151 - 160	LED on
	161 - 220	Random strobe effect slow to fast
	221 - 230	Reset Zoom after 5s
	231 - 255	LED on
12	Color and Macro	
	000 - 004	no function
	005 - 008	White 2700K
	009 - 012	White 3200K
	013 - 016	White 3500K
	017 - 020	White 4000K
	021 - 024	White 4500K
	025 - 028	White 5000K
	029 - 032	White 5600K
	033 - 036	White 6000K
	037 - 040	White 6500K
	041 - 044	White 7000K
	045 - 048	White 7500K
	049 - 052	White 8000K
	053 - 056	Mauve 126
	057 - 060	Ultimate Violet 707
	061 - 064	Dark Lavender 180
	065 - 068	Cold Lavender 703
	069 - 072	Light Lavender 052
	073 - 076	Midnight Maya 508
	077 - 080	Tokyo Blue 071
	081 - 084	Zenith Blue 195
	085 - 088	Elysian Blue 714
	089 - 092	Just Blue 079
	093 - 096	Sky Blue 068
	097 - 100	Medium Blue 132
	101 - 104	Glacier Blue 352
	105 - 108	Steel Blue 117
	109 - 112	Lagon Blue 172
	113 - 116	Peacock Blue 115
	117 - 120	Jade 323
	121 - 124	Dark Yellow Green 090
	125 - 128	Lee Green 121
	129 - 132	Fern Green 122
	133 - 136	Moss Green 089
	137 - 140	Sally Green 505
	141 - 144	Ice and a Slice 513

	145 - 148	Light Amber 102	
	149 - 152	Surprise Peach 017	
	153 - 156	Dark Salmon 008	
	157 - 160	Madge 507	
	161 - 164	Light Red 182	
	165 - 168	Scarlet 024	
	169 - 172	Pink 157	
	173 - 176	Rose Pink 002	
	177 - 180	Magical Magenta 795	
	181 - 184	Bright Pink 128	
	185 - 188	Magenta 113	
	189 - 192	Lavender Tint 003	
	193 - 200	Fade Macro 1 to 12	
	201 - 209	Fade Macro 13 to 47	
	210 - 218	Fade Macro 13 to 18	
	219 - 227	Fade Macro 19 to 29	
	228 - 236	Fade Macro 30 to 34	
	237 - 245	Fade Macro 35 to 41	
	246 - 255	Fade Macro 42 to 47	
	13	Speed	
000 - 255		slow to fast (Only can be use in CH12 193~255)	
14	Zoom		
	000 - 255	Beam to wash	

Macros table

Macro List			DMX Values	
0		No Function	0	4
1		White 2700K	5	8
	Red=	255		
	Green=	120		
	Blue=	0		
	W=	80		
2		White3200K	9	12
	Red=	251		
	Green=	130		
	Blue=	0		
	W=	93		
3		White 3500K	13	16
	Red=	255		
	Green=	143		
	Blue=	0		

Macro List			DMX Values	
25		Glacier Blue 352	101	104
	Red=	43		
	Green=	255		
	Blue=	48		
	W=	145		
26		Steel Blue 117	105	108
	Red=	255		
	Green=	223		
	Blue=	6		
	W=	179		
27		Lagon Blue 172	109	112
	Red=	9		
	Green=	255		
	Blue=	48		
	W=	0		

	W=	119		
4		White 4000K	17	20
	Red=	255		
	Green=	136		
	Blue=	0		
	W=	183		
5		White 4500K	21	24
	Red=	255		
	Green=	154		
	Blue=	0		
	W=	205		
6		White 5000K	25	28
	Red=	255		
	Green=	157		
	Blue=	0		
	W=	255		
7		White 5600K	29	32
	Red=	255		
	Green=	188		
	Blue=	11		
	W=	255		
8		White 6000K	33	36
	Red=	255		
	Green=	185		
	Blue=	15		
	W=	255		
9		White 6500K	37	40
	Red=	255		
	Green=	196		
	Blue=	23		
	W=	255		
10		White 7000K	41	44
	Red=	255		
	Green=	205		
	Blue=	30		
	W=	255		
11		White 7500K	45	48
	Red=	255		
	Green=	209		
	Blue=	38		

28		Peacock Blue 115	113	116
	Red=	50		
	Green=	255		
	Blue=	29		
	W=	0		
29		Jade 323	117	120
	Red=	42		
	Green=	255		
	Blue=	17		
	W=	0		
30		Dark Yellow Green 090	121	124
	Red=	43		
	Green=	255		
	Blue=	0		
	W=	0		
31		Lee Green 121	125	128
	Red=	255		
	Green=	237		
	Blue=	3		
	W=	0		
32		Fern Green 122	129	132
	Red=	188		
	Green=	255		
	Blue=	0		
	W=	34		
33		Moss Green 089	133	136
	Red=	150		
	Green=	255		
	Blue=	0		
	W=	0		
34		Sally Green 505	137	140
	Red=	255		
	Green=	163		
	Blue=	0		
	W=	0		
35		Ice and a Slice 513	141	144
	Red=	255		
	Green=	138		
	Blue=	0		
	W=	27		

	W=	255		
12		White 8000K	49	52
	Red=	255		
	Green=	209		
	Blue=	44		
	W=	255		
13		Mauve 126	53	56
	Red=	255		
	Green=	0		
	Blue=	31		
	W=	0		
14		Ultimate Violet 707	57	60
	Red=	213		
	Green=	56		
	Blue=	255		
	W=	0		
15		Dark Lavender 180	61	64
	Red=	91		
	Green=	0		
	Blue=	77		
	W=	255		
16		Cold Lavender 703	65	68
	Red=	255		
	Green=	110		
	Blue=	31		
	W=	42		
17		Light Lavender 052	69	72
	Red=	255		
	Green=	91		
	Blue=	14		
	W=	156		
18		Midnight Maya 508	73	76
	Red=	134		
	Green=	125		
	Blue=	255		
	W=	170		
19		Tokyo Blue 71	77	80
	Red=	0		

36		Light Amber 102	145	148
	Red=	255		
	Green=	119		
	Blue=	0		
	W=	0		
37		Surprise Peach 017	149	152
	Red=	255		
	Green=	69		
	Blue=	0		
	W=	28		
38		Dark Salmon 008	153	156
	Red=	255		
	Green=	54		
	Blue=	0		
	W=	23		
39		Madge 507	157	160
	Red=	255		
	Green=	17		
	Blue=	0		
	W=	0		
40		Light Red 182	161	164
	Red=	255		
	Green=	6		
	Blue=	0		
	W=	0		
41		Scarlet 024	165	168
	Red=	255		
	Green=	18		
	Blue=	0		
	W=	6		
42		Pink 157	169	172
	Red=	255		
	Green=	34		
	Blue=	0		
	W=	46		
43		Rose Pink 002	173	176
	Red=	255		
	Green=	0		

	Green=	0		
	Blue=	255		
	W=	0		
20		Zenith Blue 195	81	84
	Red=	0		
	Green=	255		
	Blue=	230		
	W=	0		
21		Elysian Blue 714	85	88
	Red=	0		
	Green=	255		
	Blue=	150		
	W=	194		
22		Just Blue 079	89	92
	Red=	0		
	Green=	255		
	Blue=	152		
	W=	0		
23		Sky Blue 68	93	96
	Red=	0		
	Green=	255		
	Blue=	110		
	W=	142		
24		Medium Blue 132	97	100
	Red=	0		
	Green=	255		
	Blue=	105		
	W=	3		

	Blue=	0		
	W=	129		
44		Magical Magenta 795	177	180
	Red=	255		
	Green=	0		
	Blue=	13		
	W=	57		
45		Bright Pink 128	181	184
	Red=	255		
	Green=	0		
	Blue=	8		
	W=	45		
46		Magenta 113	185	188
	Red=	255		
	Green=	0		
	Blue=	3		
	W=	10		
47		Lavander Tint 003	189	192
	Red=	255		
	Green=	110		
	Blue=	0		
	W=	108		
48		Fade macro 1 to 12	193	200
49		Fade macro 13 to 47	201	209
50		Fade macro 13 to 18	210	218
51		Fade macro 19 to 29	219	227
52		Fade macro 30 to 34	228	236
53		Fade macro 35 to 41	237	245
54		Fade macro 42 to 47	246	255

9. Control circuit diagram

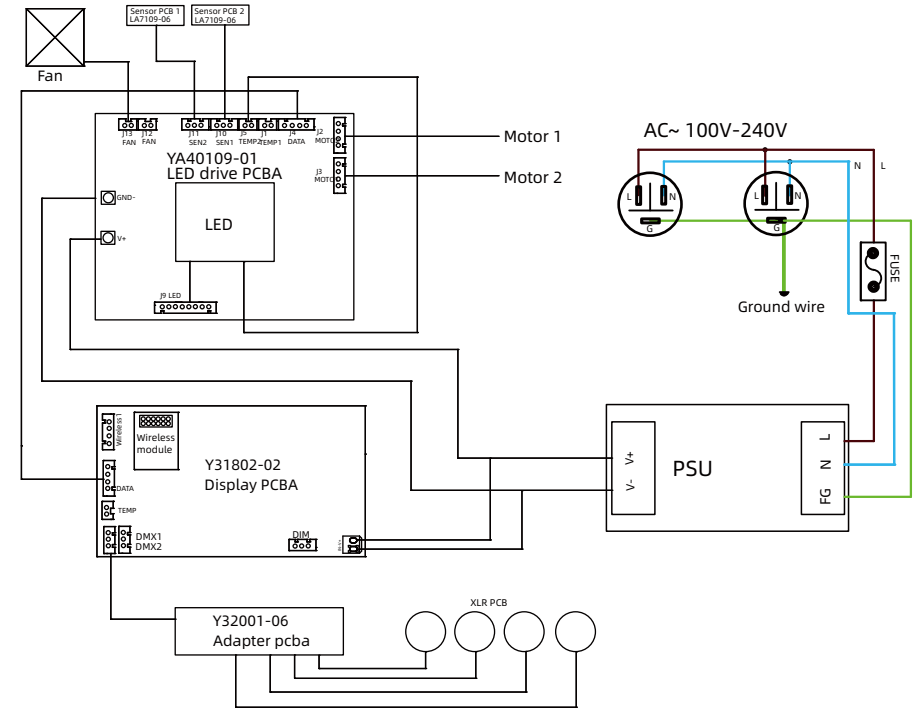

10. Regular maintenance

10.1 Cleaning and maintenance

Lighting fixtures require daily cleaning and maintenance, and their service life largely depends on the operating environment and standards. If you have any questions, please consult our technical engineers for advice. Maintenance and repair work not included in this book should be entrusted to our qualified technical engineers.



Attention! Damage caused by dust, e-liquid, or other reasons, as well as abnormal use, is not covered by the warranty.



Warning !

Before opening any lid, disconnect the power supply. Cleaning optical components requires gentle wiping as the coating surface is prone to scratching. Do not use damaging liquids or hard objects, as they may damage the plastic or coating surface.

- When the lens is cracked or otherwise damaged, it should be replaced in a timely manner;
- When the brightness significantly decreases, the LED may have reached

its expiration date and should be replaced in a timely manner;

- When the fixture cannot start, please check if the fixture power fuse is blown. If it is blown, a fuse of the same specification must be used for installation;
- The fixture is equipped with a temperature protection device. When the temperature is too high, the protection device will automatically reduce power.
- When this situation occurs, please check whether the fan is running normally, whether the fan and fan mesh are clogged with dust, identify the fault and repair it before starting the fixture. Please note that only qualified technicians are allowed to carry out maintenance work;
- To maintain smooth movement of the focusing lens, it is recommended to lubricate the guide rail of the focusing lens every three months. Excellent and high-temperature resistant lubricating grease should be used, and excessive grease should not be used as it can easily dirty adjacent components.

Weak light efficiency and uneven light spot	LED aging	Replace
	The optical mirror has accumulated dust or stains	Clean
	The optical mirror is damaged	Replace
Impure color	Weakening of light efficiency	Replace led PCB
	The color filter has accumulated dust or stains	Clean
	The color filter has been demolded or damaged	Replace
 Attention! The above analysis is for abnormal reference only. Non professionals are not allowed to disassemble and repair the machine		

10.2 Fault analysis and handling

Fault description	Analysis	Processing method
No action after power on	Check if the power switch is turned on	Turn on
	Check if the fuse is blown	Replace
	Check if the output of PSU is normal	Detecting voltage
	Check if poor contact in the internal circuit	Reconnect
Uncontrolled lighting fixtures	Check if the DMX signal cable is connected correctly (If there is no signal, the display screen will flash)	Reconnect or replace
	Check if the address code is correct and if the DMX mode of the lighting fixture matches the settings	Reconfirm
	The main control PCB is damaged	Replace
Not bright	LED aging or damage	Replace
	Power PCB malfunction	Check/ Replace
	Loose or poor contact of the circuit	Reconnect
	PSU malfunction	Replace
Automatically turn off or dim the lights	LED aging	Replace
	The temperature control switch is damaged	Replace